

# UNIT LOAD FOR UNDERWAY REPLENISHMENT CHARGE, PROPELLING 5-INCH/54 OR M72 LIGHT ARMOR WEAPON (LAW) IN PALLET ADAPTER, MK 16 MOD 0

UNIT LOAD DATA

MK 12 MOD 0    MK 12 MOD 1

NUMBER OF CARTRIDGES PER TANK. . . . . 1  
 NUMBER OF TANKS PER UNIT LOAD. . . . . 39  
 NUMBER OF CARTRIDGES PER UNIT LOAD . . . . 39  
 WEIGHT OF ADAPTER . . . . . 54 LBS  
 WEIGHT OF STEEL STRAPPING. . . . . 7 LBS  
 WEIGHT OF PALLET. . . . . 110 LBS  
 DIMENSION .A. . . . . 43-7/8 IN  
 CUBE . . . . . 44.3 CU FT

72 LBS  
 43 IN  
 43.9 CU FT

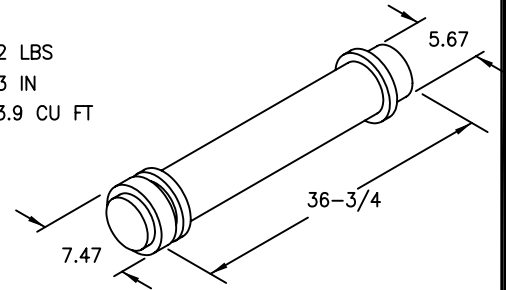

5" 54 CARTRIDGE TANK  
 MK 14 - 389112  
 MK 14 MOD 1 - 10001-2127876  
 MK 21 MOD 1 - 1366407  
 MK 14 MOD 2 - 10001-2127964  
 MK 14 MOD 3 - 10001-2127977

TANK	GROSS WT OF ONE TANK (LOADED)	△ GROSS WEIGHT OF UNIT LOAD WITH	
		MK 12 MOD 0 PALLET	MK 12 MOD 1 PALLET
MK 14	39.1 LBS	1,696 LBS	1,658 LBS
MK 14 MOD 1	41.5 LBS	1,790 LBS	1,752 LBS
MK 21 MOD 0	42.0 LBS	1,809 LBS	1,771 LBS
REDUCED, MK 14	32.0 LBS	1,419 LBS	1,381 LBS
MK 14 MOD 2	41.5 LBS	1,790 LBS	1,752 LBS
MK 14 MOD 3	41.5 LBS	1,790 LBS	1,752 LBS

△ DO NOT USE FOR SHIPPING PURPOSES

DODIC/NALC

D297    D309  
 D304    D310  
 D305    D324  
 D308    D326

**CAUTION**

FRONT AND REAR FRAMES MUST BE CORRECTLY POSITIONED TO ENSURE A PROPERLY PALLETIZED LOAD. WHEN IDENTIFICATION MARKING IS NOT LEGIBLE, FRONT AND REAR FRAMES MAY BE IDENTIFIED BY COMPARING THEIR CROSS SECTIONS, ON PAGE 3.

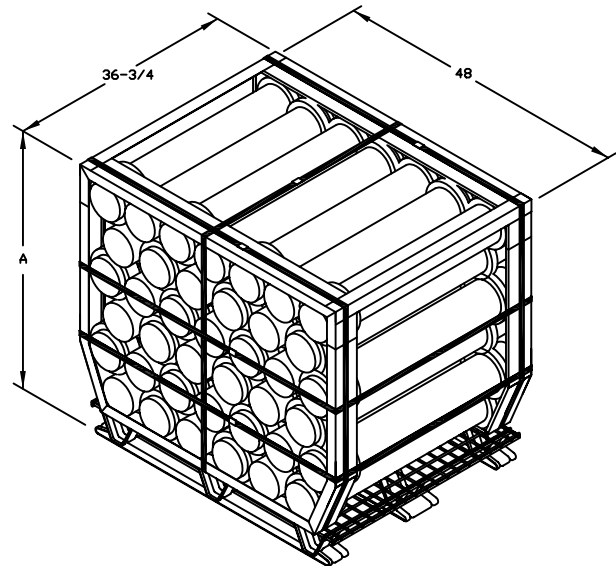

NOTES:

1. UNLESS OTHERWISE SPECIFIED, DIMENSIONS ARE IN INCHES.
2. SEE SW020-AC-SAF-010 FOR THE FOLLOWING INFORMATION:  
 A) CROSS REFERENCE TO ASSOCIATED TRUCKLOADING AND CONTAINER LOADING MILITARY STANDARDS.  
 B) HAZARD CLASSIFICATION
3. FOR UNIT LOAD QUALIFICATION, SEE PHST TEST REPORT 86265
4. DO NOT STACK MORE THAN 4 UNIT LOADS HIGH IN STORAGE.

-	ORIGINAL ISSUE - SUPERSEDES MIL-STD-1323-5	8/3/05	S/JM	S/RS
REV.	REVISION DESCRIPTION	DATE	TDA	SYSCOM

TECH DATA MANAGEMENT SUPERVISOR	S/JM	8/3/05
SYSTEMS ENG. SUPERVISOR	S/RL	8/3/05
S/ROY SMITH    8/3/05		
NAVSEASYSYSCOM ( BY DIRECTION )		

DISTRIBUTION STATEMENT A  
 APPROVED FOR PUBLIC RELEASE: DISTRIBUTION IS UNLIMITED

THIS TRUCKLOAD IS AUTHORIZED AND RELEASED  
 FOR HIGHWAY SHIPMENT ONLY.

DEPARTMENT OF THE NAVY NAVAL SEA SYSTEMS COMMAND WASHINGTON, D.C., 20362	CAGE CODE 53711	DWG NO. 7516504	REV. -
SIZE A	PAGE 1 OF 3		

# PALLETIZING PROCEDURES

- (A) THREAD THE LONGITUDINAL STRAPPING, ITEM 5, BETWEEN DECK WIRES OF PALLET, ITEM 1, AS SHOWN IN DETAIL A.
- (B) USING MK 12 MOD 1 PALLET, THREAD THE LATERAL STRAP, ITEM 7, UNDER DECK WIRES AND THROUGH THE CENTER VERTICAL SUPPORT OF PALLET. USING MK 12 MOD 0 PALLET, THREAD THE LATERAL STRAP, ITEM 7, BETWEEN DECK WIRES AND DECK SUPPORT AS SHOWN IN DETAIL D.
- (C) POSITION THE FRONT FRAME, ITEM 2, AND REAR FRAME, ITEM 3, ALONG THE LENGTHWISE DIMENSION OF THE PALLET. SEE DETAILS B AND C FOR PROPER IDENTIFICATION OF FRONT AND REAR FRAMES. POSITION THE FIRST TANK WITH THE COVER END IN THE RIGHT END OF THE FRONT FRAME AND ALTERNATE END POSITIONS OF THE NEXT FIVE TANKS IN THE FIRST ROW, AS SHOWN.
- (D) POSITION THE SECOND ROW OF TANKS, WITH THE COVER END OF THE FIRST TANK IN THE RIGHT END CORNER OF THE FRONT FRAME, ALTERNATING END POSITIONS OF THE SUCCEEDING TANKS, AS SHOWN.
- (E) POSITION THE LOWER GIRTHWISE STRAPPING, ITEM 6, AND APPLY LIGHT TENSION.
- (F) POSITION THE NEXT TWO ROWS OF TANKS, WITH COVER ENDS OF THE FIRST TANK IN EACH ROW AT THE RIGHT END OF THE FRONT FRAME, ALTERNATING END POSITIONS OR SUCCEEDING TANKS, AS SHOWN.
- (G) COMPLETE TENSIONING OF THE LOWER GIRTHWISE STRAP AND DOUBLE NOTCH SEAL, ITEM 8.
- (H) POSITION THE UPPER GIRTHWISE STRAPPING AND APPLY LIGHT TENSION.
- (I) REPEAT PROCEDURE (F) FOR THE NEXT TWO ROWS, AS SHOWN.
- (J) COMPLETE TENSIONING OF THE UPPER GIRTHWISE STRAP AND DOUBLE NOTCH SEAL.
- (K) POSITION THE TOP FRAME, ITEM 4.
- (L) THREAD THE LONGITUDINAL STRAPPING THROUGH THE LOOPS IN THE FRONT AND REAR FRAMES AND OVER THE TOP FRAME. TENSION AND DOUBLE NOTCH SEAL.
- (M) POSITION THE LATERAL STRAP AROUND THE UNIT LOAD, TENSION AND DOUBLE NOTCH SEAL.

MARKING: IN ADDITION TO ANY SPECIAL MARKING REQUIRED BY CONTRACT OR ORDER, THE UNIT LOAD SHALL BE MARKED IN ACCORDANCE WITH 28620-ACV00561

# DEPALLETIZING PROCEDURES

- (A) CUT AND REMOVE THE LATERAL AND LONGITUDINAL STRAPPING.
- (B) REMOVE THE TOP FRAME.
- (C) REMOVE THREE ROWS OF TANKS.
- (D) CUT AND REMOVE THE UPPER GIRTHWISE STRAP.
- (E) REMOVE TWO ROWS OF TANKS.
- (F) CUT AND REMOVE THE LOWER GIRTHWISE STRAP.
- (G) REMOVE THE REMAINING TANKS AND THE FRONT AND REAR FRAMES.

### NOTE:

1. UNLESS OTHERWISE SPECIFIED, ALL MATERIAL SHALL BE IN ACCORDANCE WITH MIL-STD-1323.
2. STRAPPING SHALL CONFORM TO ASTM D3953, FLAT, TYPE 1, HEAVY DUTY, FINISH B, GRADE 2.
3. SEALS SHALL CONFORM TO ASTM D3953, CLASS H, FINISH B, GRADE 2, STYLE I, II OR IV.
4. DO NOT USE TYPE 1 STRAPPING WITH POWER MACHINES.

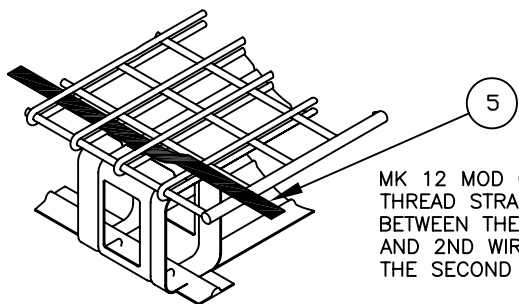

MK 12 MOD 0 PALLET  
THREAD STRAPPING  
BETWEEN THE 1ST  
AND 2ND WIRE, IN  
THE SECOND SPACE.

DETAIL A

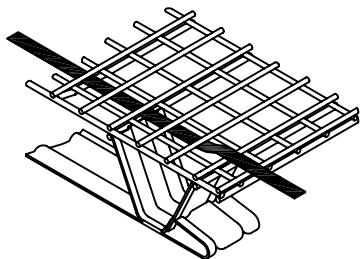

MK 12 MOD 1 PALLET  
THREAD STRAPPING  
BETWEEN THE 2ND  
AND 3RD WIRE, IN  
THE SECOND SPACE.

5	8	SEAL	STEEL	SEE NOTES 1 & 3	3/4
1	7	STRAPPING, LATERAL	STEEL	SEE NOTES 1, 2 & 4	3/4 X .035 (OR .031) X 13 FT 6
2	6	STRAPPING, GIRTHWISE	STEEL	SEE NOTES 1, 2 & 4	3/4 X .035 (OR .031) X 15 FT
2	5	STRAPPING, LONGITUDINAL	STEEL	SEE NOTES 1, 2 & 4	3/4 X .035 (OR .031) X 15 FT 6
1	4	TOP FRAME, PALLET ADAPTER, MK 16 MOD 0	STEEL	10001-1372831 LD 296489	
1	3	REAR FRAME, PALLET ADAPTER, MK 16 MOD 0	STEEL	10001-13722830 LD 296489	
1	2	FRONT FRAME, PALLET ADAPTER, MK 14 MOD 0	STEEL	10001-1372829 LD 296489	
1	1	PALLET MK 12 MOD 0 MK 12 MOD 1	STEEL	10001-1372829 10001-2645217	35 X 45-1/2 X 5-1/8 35 X 45-1/2 X 4-3/4
REQ	ITEM	DESCRIPTION	MAT'L	SPECIFICATIONS	DIMENSIONS

### LIST OF MATERIALS

# PALLETIZING DETAILS

CROSS SECTION OF FRONT FRAME

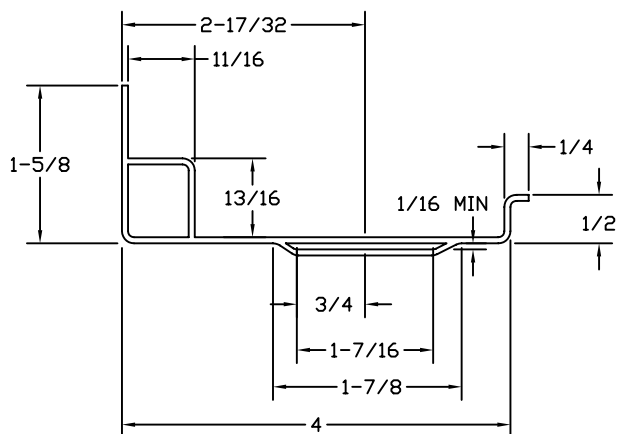

DETAIL B

CROSS SECTION OF REAR FRAME

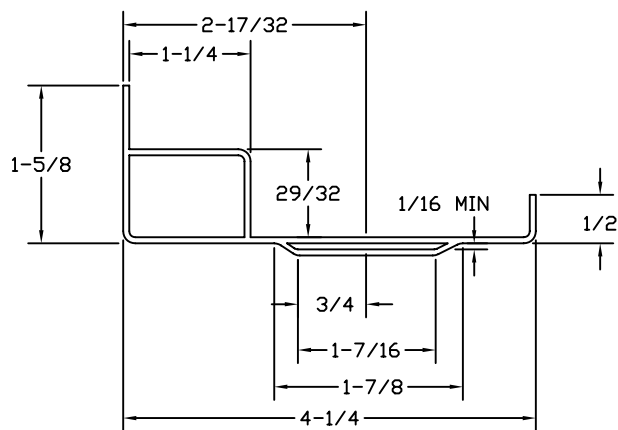

DETAIL C

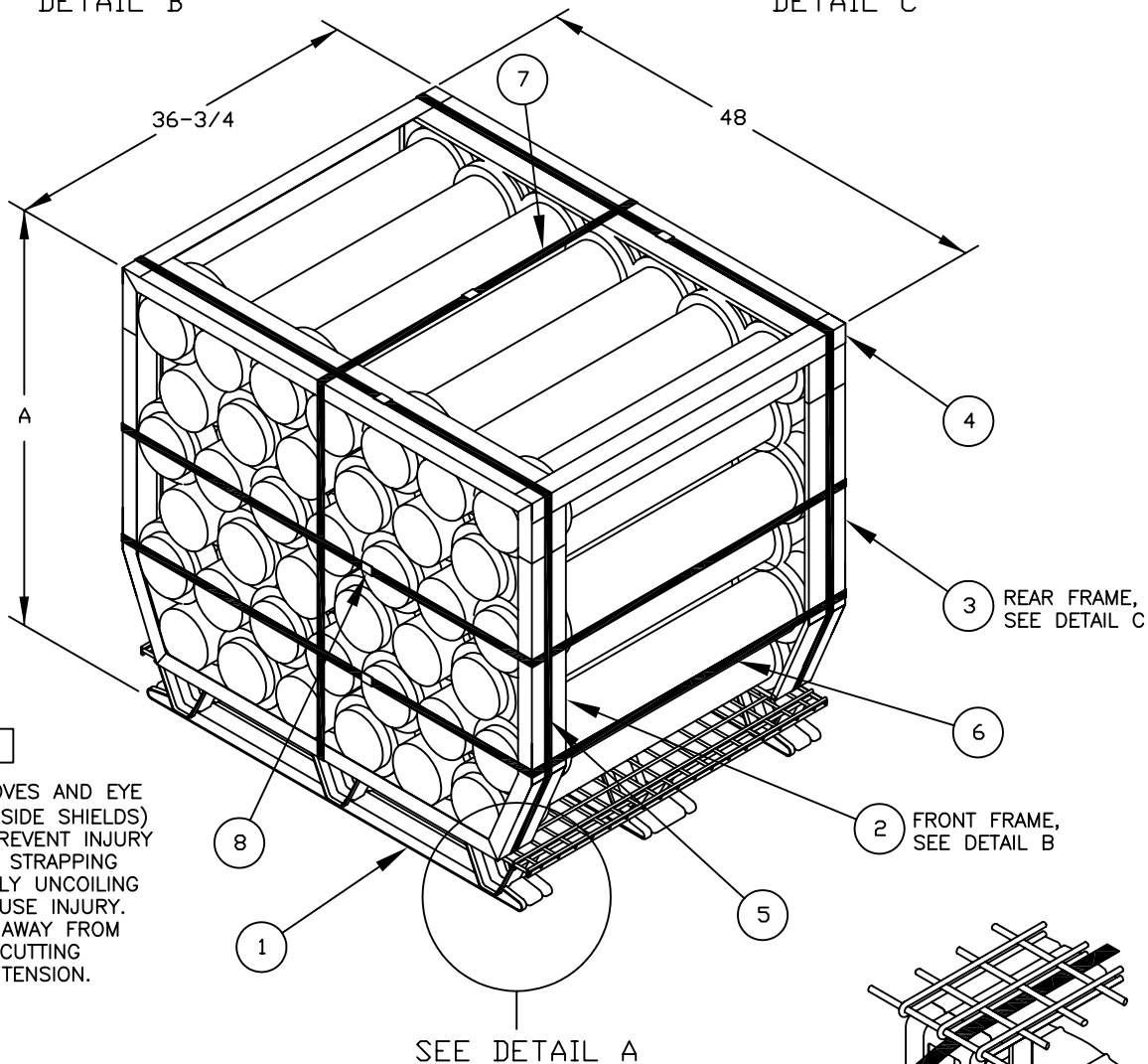

**WARNING**

WEAR LEATHER GLOVES AND EYE PROTECTION (WITH SIDE SHIELDS) OR GOGGLES TO PREVENT INJURY WHEN PERFORMING STRAPPING OPERATIONS. RAPIDLY UNCOILING STRAPPING MAY CAUSE INJURY. DIRECT STRAPPING AWAY FROM PERSONNEL WHEN CUTTING STRAPPING UNDER TENSION.

**NOTE:**

1. SEE DETAIL B AND C FOR PROPER IDENTIFICATION OF THE FRONT AND REAR FRAMES BEFORE POSITIONING THE TANKS.
2. SEE DETAIL D FOR PROPER PLACEMENT OF LATERAL STRAPPING, ITEM 7, WITH MK 12 MOD 0 PALLET.

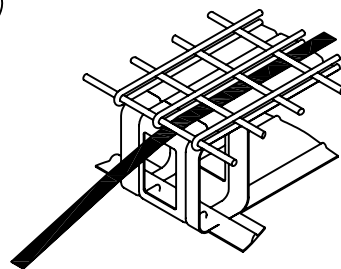

DETAIL D