

STORAGE IN APPROVED STRUCTURES OF CBU-87/B AND CBU-89/B MUNITIONS PACKED IN CNU-327/E SERIES METAL CONTAINERS

INDEX

<u>ITEM</u>	<u>PAGE(S)</u>
GENERAL NOTES AND MATERIAL SPECIFICATIONS - - - - -	2
DETAILS - - - - -	3
STORAGE PROCEDURES (EARTH-COVERED MAGAZINES):	
81'-0", 60'-8" AND 40'-4" L X 26'-6" W X 12'-9" H IGLOO MAGAZINES - -	4-5
81'-2" L X 26'-6" W X 12'-1-3/4" H ARCH TYPE MAGAZINE - - - - -	6-7
80'-0" AND 40'-0" L X 25'-0" W X 12'-1-3/4" H ARCH TYPE MAGAZINES - -	8-9
80'-0" AND 40'-0" L X 25'-0" W X 11'-0" H ARCH TYPE MAGAZINES - - -	10-11
80'-0" AND 40'-0" L X 25'-0" W X 10'-0" H ARCH TYPE MAGAZINES - - -	12-13
80'-0" L X 25'-0" W X 14'-0" H STRADLEY MAGAZINE - - - - -	14-15
89'-0" L X 24'-10" W X 14'-4" H OVAL ARCH MAGAZINE - - - - -	16-17
52'-0" DIAMETER CORBETTA MAGAZINE - - - - -	18-19
100'-8" L X 50'-0" W RECTANGULAR MAGAZINE - - - - -	20-21
TYPICAL STORAGE PROCEDURES (EARTH COVERED BUNKERS):	
60'-0" L X 40'-0" W X 15'-0" H TYPE II BUNKER - - - - -	22-23
60'-0" L X 40'-0" W X 11'-0" H TYPE III BUNKER - - - - -	24-25
40'-0" L X 20'-0" W X 11'-0" H TYPE IV BUNKER - - - - -	26-27
TYPICAL MULTIPLE-LOT STORAGE PROCEDURES:	
IGLOO AND ARCH TYPE MAGAZINES - - - - -	28
STRADLEY AND OVAL ARCH TYPE MAGAZINES - - - - -	29
CORBETTA MAGAZINE - - - - -	30-31
RECTANGULAR MAGAZINE - - - - -	32
TYPE II BUNKER - - - - -	33
TYPE III BUNKER - - - - -	34

U. S. ARMY MATERIEL COMMAND DRAWING			
APPROVED, U.S. ARMY INDUSTRIAL OPERATIONS COMMAND <i>Ngh</i> <i>David A. Pichorik</i> SMCAR-ESK	DRAFTSMAN	D. WHITMORE	
APPROVED BY ORDER OF COMMANDING GENERAL U.S. ARMY MATERIEL COMMAND <i>Sary W. Kelly</i> U.S. ARMY DEFENSE AMMUNITION CENTER AND SCHOOL	ENGINEER	M. DAEUMER	
	SUPPLY ENGINEERING DIVISION	<i>J Sprague</i>	
	LOGISTICS ENGINEERING OFFICE	<i>Thomas J. Michels</i>	
JULY 1987			
	CLASS	DIVISION	DRAWING
	19	48	7101
REVISION NO. 1	NOVEMBER 1995		SP1-3-4-14-22J17
SEE REVISION LISTING ON PAGE 2			

DO NOT SCALE

GENERAL NOTES

- A. THIS DOCUMENT HAS BEEN PREPARED AND ISSUED IN ACCORDANCE WITH AR 740-1 AND AUGMENTS TM 743-200-1 (CHAPTER 5).
- B. THE STORAGE PROCEDURES SPECIFIED HEREIN ARE APPLICABLE TO CBU-87/B AND CBU-89/B MUNITIONS PACKED IN CNU-327/E CONTAINERS ONLY. SEE THE CONTAINER DETAIL LOCATED ON PAGE 3. SUBSEQUENT REFERENCE TO CONTAINER MEANS THE CNU-327/E CONTAINER WITH CONTENTS.
- C. THE STORAGE PROCEDURES DEPICTED WITHIN THIS DOCUMENT ARE APPLICABLE FOR STORAGE IN VARIOUS TYPES AND SIZES OF MAGAZINES. THE STORAGE PROCEDURES DEPICTED FOR THE SPECIFIC TYPES OF MAGAZINES MAY ALSO BE UTILIZED TO STORE CONTAINERS IN OTHER TYPES OF APPROVED MAGAZINES. MINOR ADJUSTMENTS MAY BE MADE TO FACILITATE STORAGE IN OTHER TYPES OF MAGAZINES, HOWEVER, THE BASIC PRINCIPLES AS DEPICTED HEREIN WILL BE FOLLOWED.
- D. CAUTION: THE ALLOWABLE "EXPLOSIVE LIMIT" ESTABLISHED FOR A MAGAZINE IS NOT TO BE EXCEEDED. THIS LIMITATION MAY REQUIRE A QUANTITY REDUCTION FROM THE STORAGE AS SHOWN.
- E. AISLE DIMENSIONS AS SHOWN HEREIN MAY BE ADJUSTED TO SUIT LOCAL CONDITIONS AND/OR AVAILABLE MATERIAL HANDLING EQUIPMENT (MHE). HOWEVER, AN 18" MINIMUM INSPECTION AISLE MUST BE MAINTAINED AT THE END OF CONTAINERS WHERE HUMIDITY INDICATORS ARE LOCATED.
- F. THE MAXIMUM FLOOR LOAD FOR A MAGAZINE AS PRESCRIBED BY LOCAL STANDARDS WILL NOT BE EXCEEDED.
- G. THE USE OF "FLOOR DUNNAGE" UNDER EACH FIRST-LAYER CONTAINER IS OPTIONAL, ALTHOUGH THE USE OF THIS TYPE OF DUNNAGE IS DELINEATED WITHIN THIS STORAGE PROCEDURE DRAWING. THE PURPOSE OF FLOOR DUNNAGE IS TO HELP KEEP THE RUNNERS OF A CONTAINER DRY, THUS AIDING IN PREVENTING DETERIORATION DUE TO CORROSION. THEREFORE, FLOOR DUNNAGE SHOULD BE USED WHEN STORING IN A MAGAZINE THAT IS KNOWN TO HAVE A "DAMP" FLOOR. ALSO, IN LIEU OF USING ONE-INCH THICK FLOOR DUNNAGE AS SPECIFIED, THE USE OF THICKER FLOOR DUNNAGE MAY BE REQUIRED, AND SHOULD BE USED IF REQUIRED, TO ACHIEVE THE DESIRED OBJECTIVE.
- H. IF AVAILABLE MHE PERMITS, ADDITIONAL CONTAINERS MAY BE STORED WITHIN THE MHE AREA AND/OR OTHER AVAILABLE AREA OF THE MAGAZINE.
- J. STORED CONTAINERS MUST NOT CONTACT THE WALLS OF A MAGAZINE. TO PROVIDE FOR THIS MANDATORY CLEARANCE REQUIREMENT, CONTAINERS MAY BE ELIMINATED FROM THE DEPICTED STORAGE PATTERN AS NECESSARY.
- K. OTHER COMPATIBLE ITEMS MAY BE STORED IN A MAGAZINE WHICH IS PARTIALLY FILLED WITH THE DESIGNATED ITEM.
- L. THE HEIGHT OF THE PACKAGE GUARD ON SOME FORKLIFT TRUCKS MAY NOT PERMIT PLACEMENT OF SOME TOP LAYER CONTAINERS IN THE STACKS SHOWN IN THE STORAGE VIEWS HEREIN, UNLESS TWO UPPER CONTAINERS ARE HANDLED AS ONE LIFT OR THE PACKAGE GUARD IS REMOVED (TINE CARRIAGE WILL IN MOST INSTANCES PROVIDE ADEQUATE PACKAGE GUARD PROTECTION). ONLY A FORKLIFT TRUCK OF ADEQUATE CAPACITY WILL BE USED WHEN LIFTING TWO CONTAINERS AS ONE LIFT.
- M. ANY CONTAINER THAT DOES NOT CONTAIN TWO (2) ROUNDS WILL NOT BE BURIED IN STORAGE. IT MUST BE POSITIONED ON TOP OF THE LAST STACK ADJACENT TO OR NEAREST THE MAGAZINE DOOR.
- N. STORAGE OF MULTIPLE LOTS IN A MAGAZINE WILL REQUIRE CAREFUL PRE-PLANNING SO AS TO INSURE MHE ACCESSIBILITY TO ANY LOT IN ACCORDANCE WITH REQUIREMENTS SET FORTH IN THE APPLICABLE "SPECIAL NOTES" SECTIONS OF THE MULTIPLE LOT STORAGE PROCEDURES TYPICALLY SHOWN ON PAGES 28 THRU 34.
- O. ALTHOUGH SPECIFIC PROCEDURES ARE INCLUDED IN THIS DRAWING FOR STORING MULTIPLE LOTS WITHIN ONE STRUCTURE, THE BASIC STORAGE PATTERN AS SHOWN ON PAGES 4 THRU 27 CAN ALSO BE ADAPTED FOR THE STORING OF MORE THAN ONE LOT. LOTS WHEN STORED IN ACCORDANCE WITH A BASIC STORAGE PATTERN MAY BE STORED WITH ONE OR MORE ROWS USED FOR EACH LOT. A SPACE OF APPROXIMATELY 1" WILL HAVE TO BE LEFT BETWEEN ADJACENT ROWS CONTAINING DIFFERENT LOTS.

(CONTINUED AT RIGHT)

MATERIAL SPECIFICATIONS

LUMBER - - - : FED SPEC MM-L-751; DUNNAGE LUMBER, SEE TM 743-200-1.

(GENERAL NOTES CONTINUED)

- P. FOR ADDITIONAL REQUIREMENTS AND GUIDANCE, SEE THE SPECIAL NOTES FOR MULTIPLE-LOT STORAGE ON PAGES 28 THRU 34.
- Q. IF THE QUANTITY OF CONTAINERS FOR A MAGAZINE IS TO BE REDUCED FROM WHAT IS SHOWN HEREIN-DUE TO THE PERMITTED "EXPLOSIVE LIMIT" OR FOR ANY OTHER REASON, SUCH AS A LIMITED QUANTITY TO BE STORED, THE DELINEATED PROCEDURES ARE TO BE ADJUSTED BY OMITTING STACKS RATHER THAN BY OMITTING LAYERS.
- R. DUNNAGE LUMBER SPECIFIED THROUGHOUT THIS PROCEDURAL DRAWING IS OF NOMINAL SIZE. FOR EXAMPLE, 1" X 6" MATERIAL IS ACTUALLY 3/4" THICK BY 5-1/2" WIDE.
- S. CONVERSION TO METRIC EQUIVALENTS: DIMENSIONS WITHIN THIS DOCUMENT ARE EXPRESSED IN INCHES, AND WEIGHTS ARE EXPRESSED IN POUNDS. WHEN NECESSARY, THE METRIC EQUIVALENT MAY BE COMPUTED ON THE BASIS OF ONE INCH EQUALS 25.4 MM, AND ONE POUND EQUALS 0.454 KG.
- T. PORTIONS OF THE MAGAZINES, SUCH AS SIDEWALLS, END WALLS, AND ROOFS, HAVE NOT BEEN SHOWN IN THE STORAGE VIEWS FOR CLARITY PURPOSES.
- U. CONTAINERS PRESENTLY STORED IN ACCORDANCE WITH A PRIOR APPROVED DRAWING NEED NOT BE RE-STORED SOLELY TO CONFORM TO THE PROCEDURES SPECIFIED IN THIS DOCUMENT.
- V. FOR ADDITIONAL GUIDANCE, ATTENTION IS DIRECTED TO THE "SPECIAL NOTES" SECTIONS WHICH ARE INCLUDED WITH THE DEPICTED STORAGE METHODS.

REVISIONS

REVISION NO. 1, DATED NOVEMBER 1995, CONSISTS OF:

1. CONVERTING TO CAD.

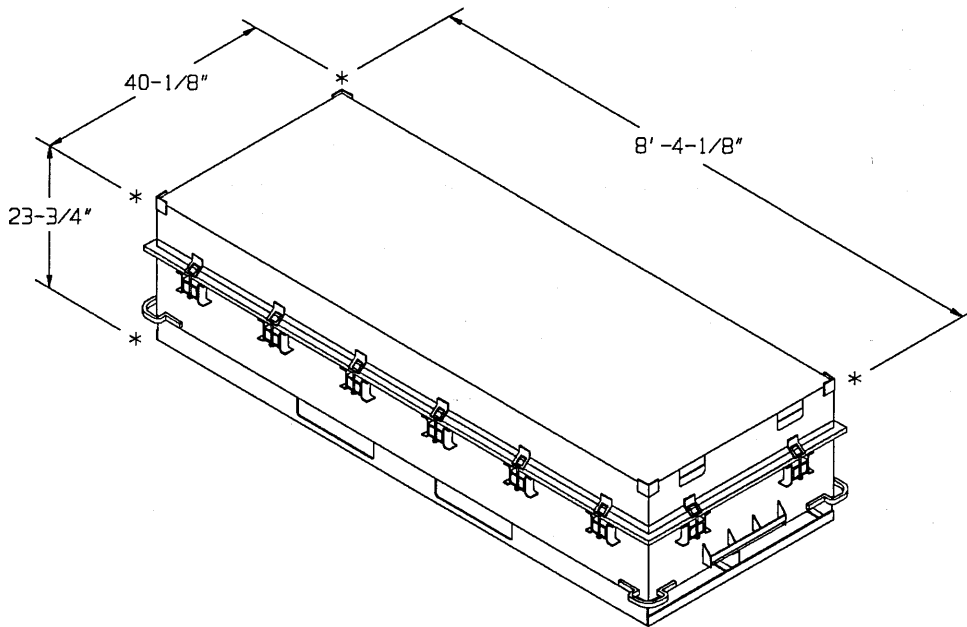

CONTAINER DETAIL

CUBE	-----	55.2 CUBIC FEET (APPROX)
GROSS WEIGHT (CBU-87/B)	-----	2,486 LBS (APPROX)
GROSS WEIGHT (CBU-89/B)	-----	1,886 (APPROX)

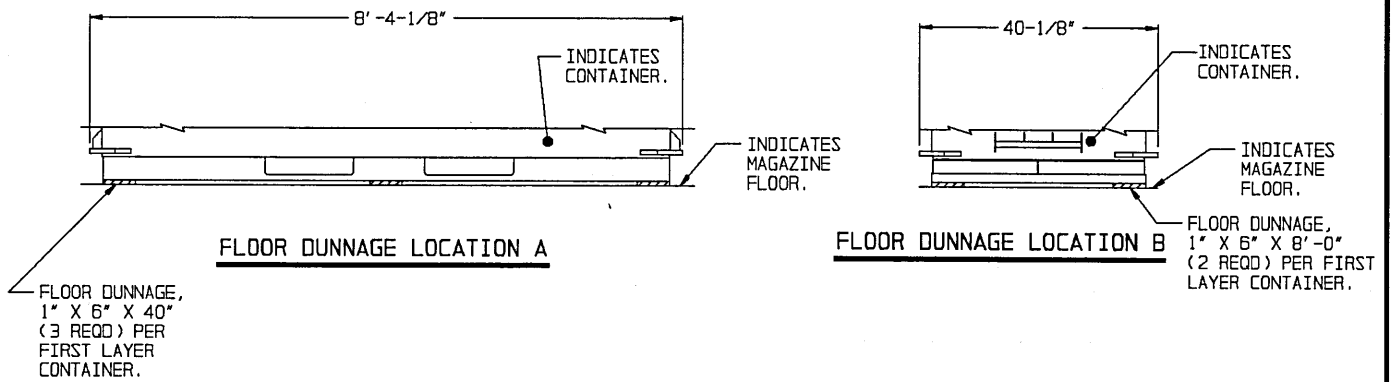

DETAILS

STORAGE IN 81'-0" IGLOO
(12'-9" HIGH)

ITEM	QUANTITY
CONTAINERS	193

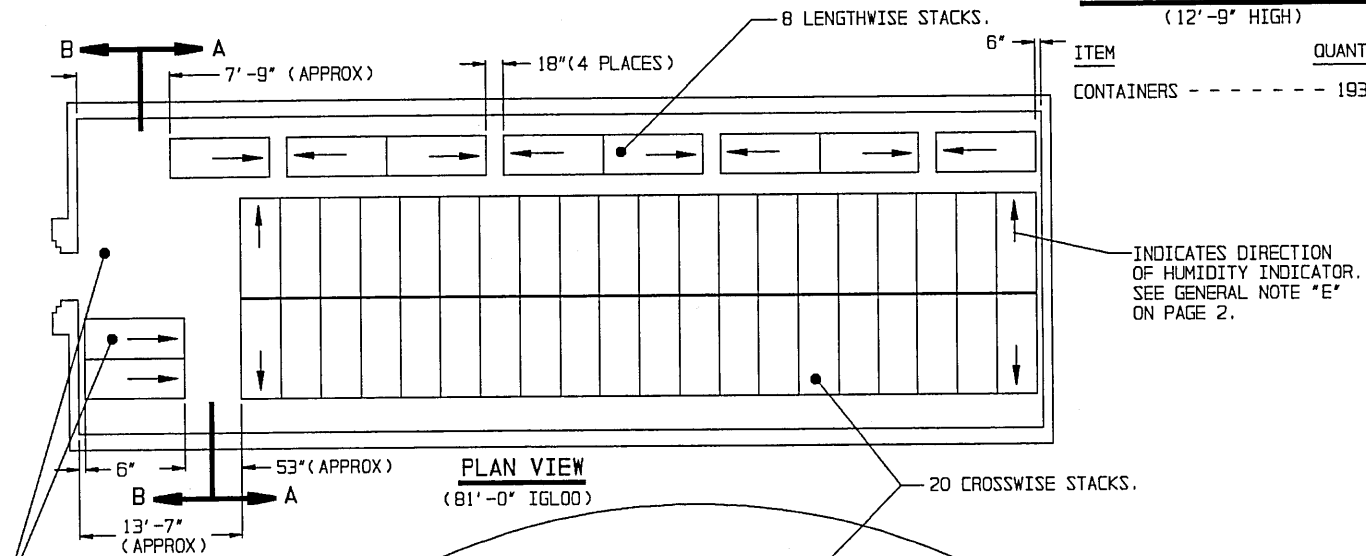

SEE GENERAL NOTE "H" ON PAGE 2.

SEE GENERAL NOTE "J" ON PAGE 2.

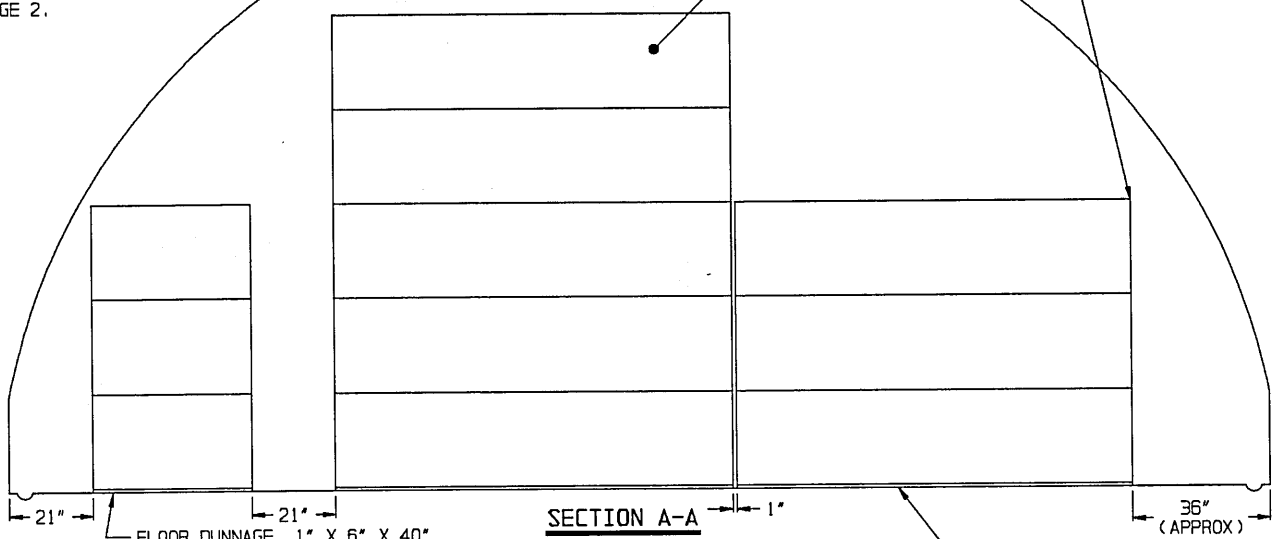

FLOOR DUNNAGE, 1" X 6" X 40"
(3 REQD PER FIRST-LAYER CONTAINER)
SEE THE "FLOOR DUNNAGE LOCATION A" DETAIL ON PAGE 3.

FLOOR DUNNAGE, 1" X 6" X 8'-0"
(2 REQD PER FIRST-LAYER CONTAINER).
SEE THE "FLOOR DUNNAGE LOCATION B" DETAIL ON PAGE 3 AND GENERAL NOTE "G" ON PAGE 2.

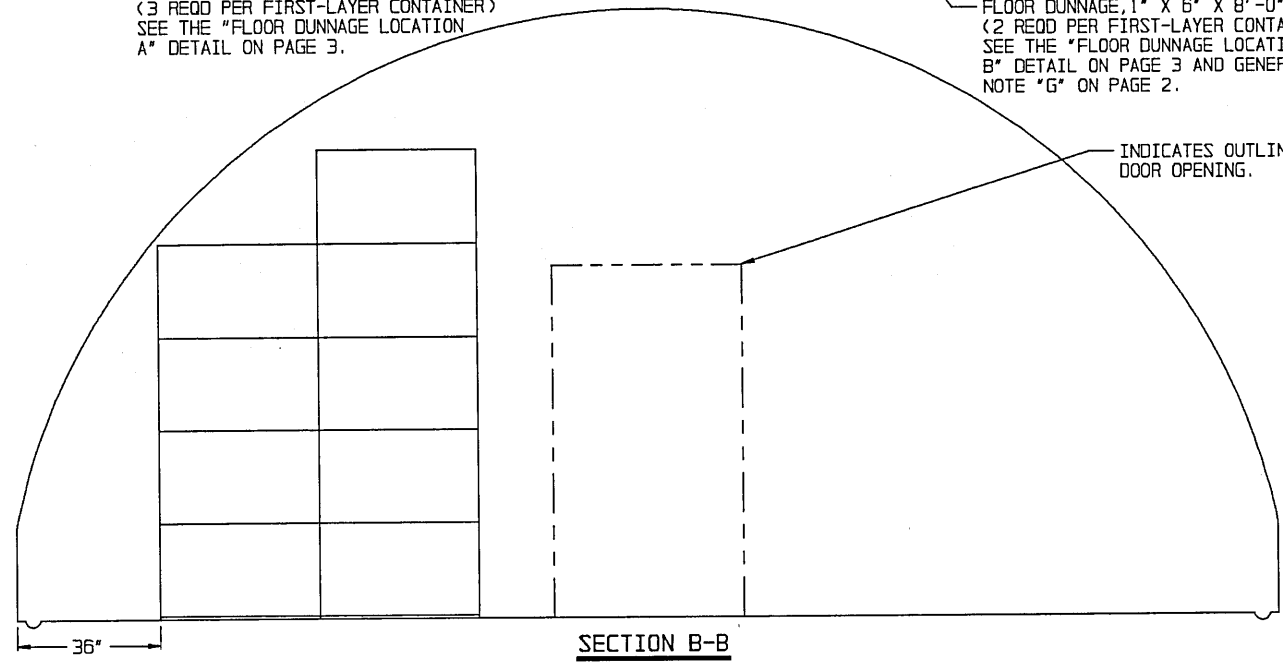

STORAGE IN 60'-8" IGL00

(12'-9" HIGH)

ITEM	QUANTITY
CONTAINERS - - - - -	139

*** STORAGE IN 40'-4" IGL00**

(12'-9" HIGH)

ITEM	QUANTITY
CONTAINERS - - - - -	85

* 4 LENGTHWISE STACKS
8 CROSSWISE STACKS

INDICATES DIRECTION OF HUMIDITY INDICATOR, SEE GENERAL NOTE "E" ON PAGE 2.

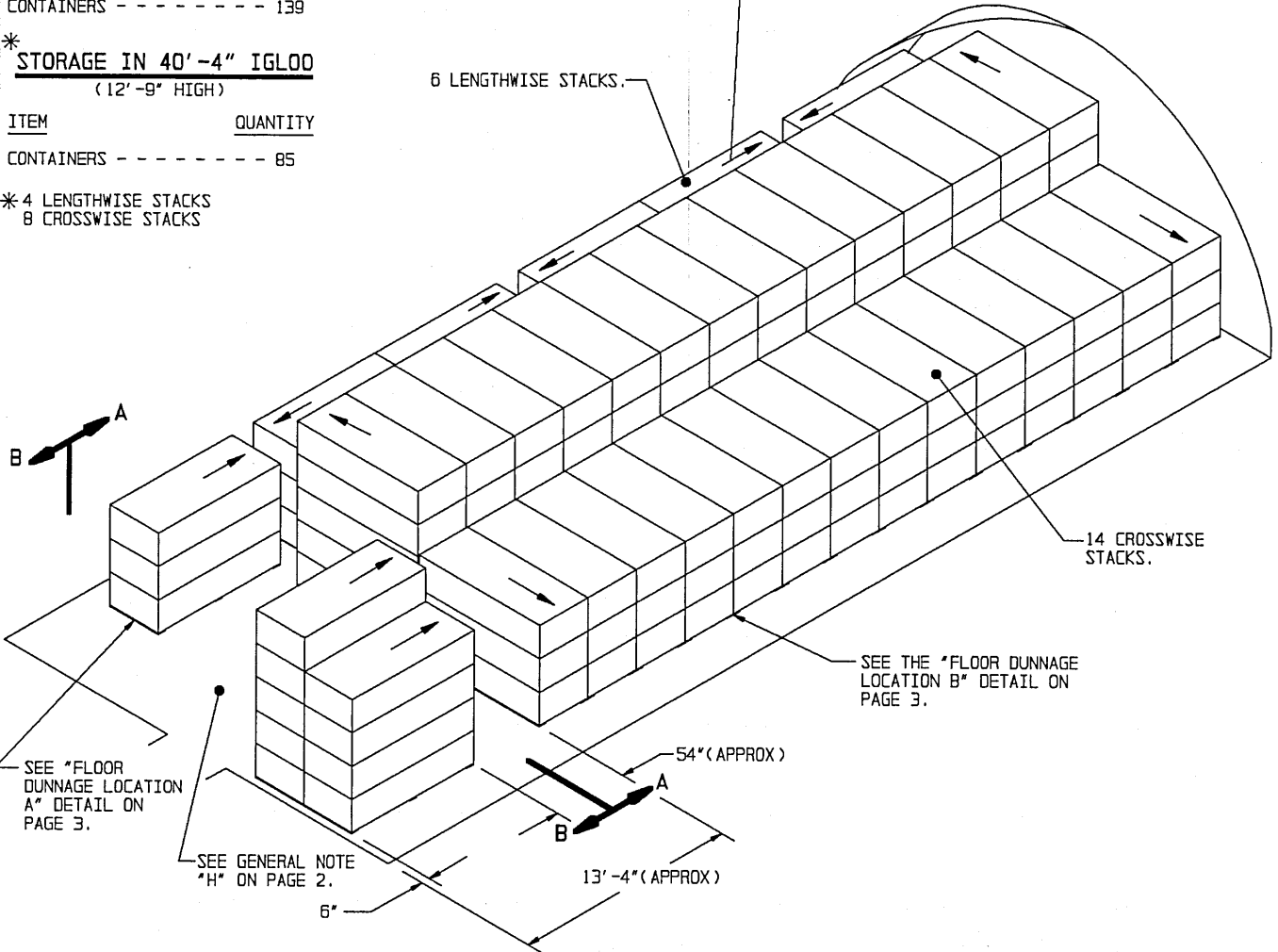

ISOMETRIC VIEW
(60'-8" IGL00)

FOR "GENERAL NOTES" AND "MATERIAL SPECIFICATIONS", SEE PAGE 2.

BILL OF MATERIAL (PER STACK) *		
TYPE OF STACK	1" X 6" DUNNAGE LUMBER	
	LINEAR FEET	BOARD FEET
LENGTHWISE	10	5
CROSSWISE	16	8

* SEE GENERAL NOTE "G" ON PAGE 2.

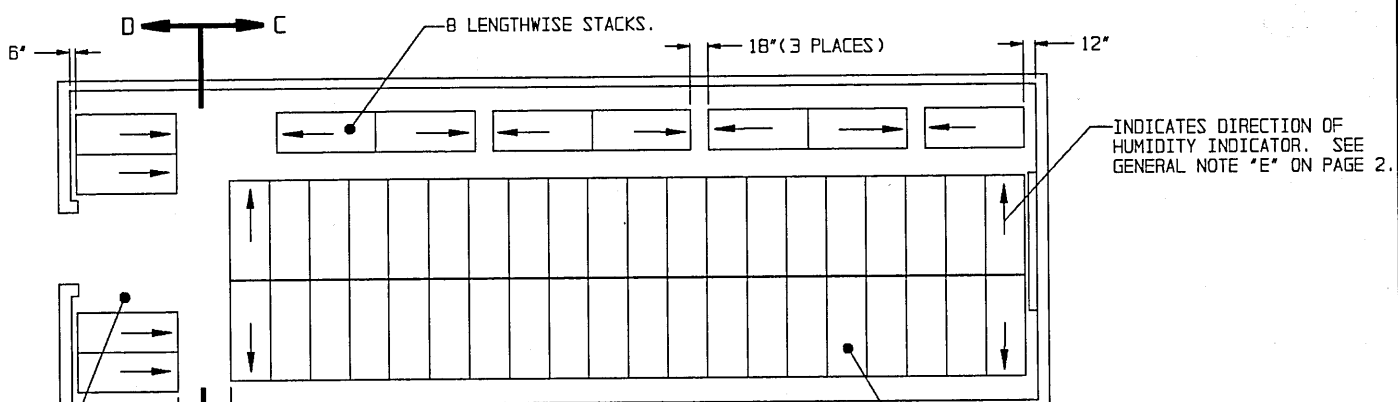

PLAN VIEW
(81'-2" MAGAZINE)

SEE GENERAL NOTE "H" ON PAGE 2.

SEE GENERAL NOTE "J" ON PAGE 2.

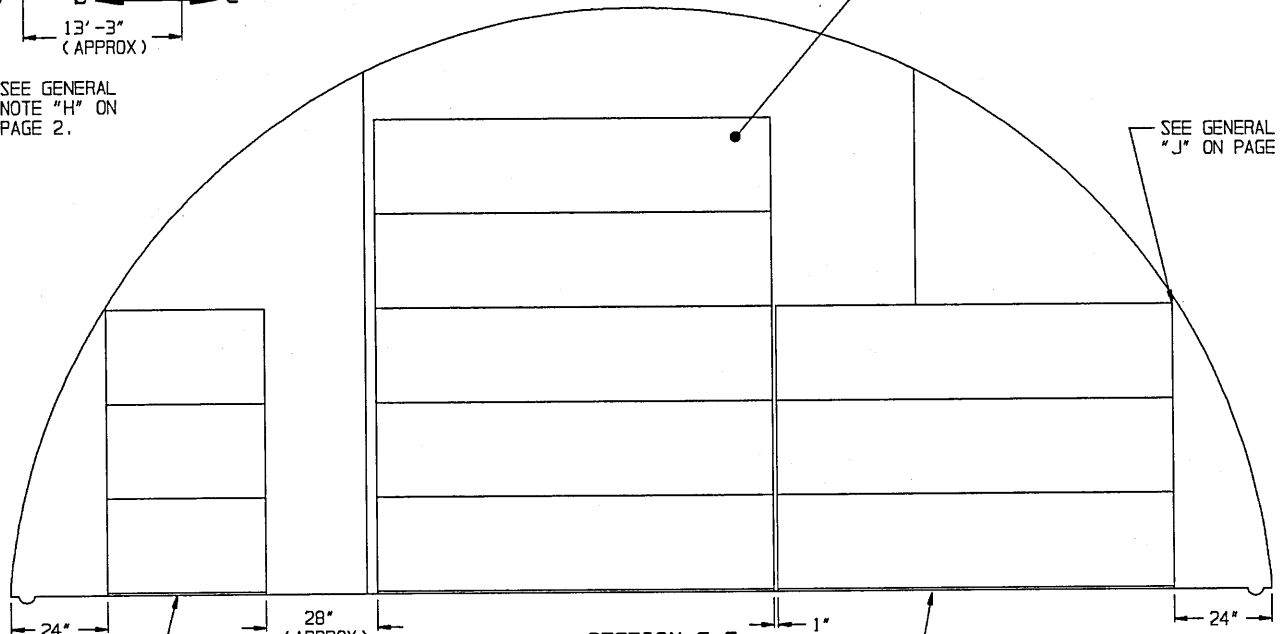

SECTION C-C

FLOOR DUNNAGE, 1" X 6" X 40"
(3 REOD PER FIRST-LAYER CONTAINER).
SEE THE "FLOOR DUNNAGE LOCATION A"
DETAIL ON PAGE 3.

FLOOR DUNNAGE, 1" X 6" X 8'-0"
(2 REOD PER FIRST-LAYER CONTAINER).
SEE THE "FLOOR DUNNAGE LOCATION B"
DETAIL ON PAGE 3 AND GENERAL NOTE "G"
ON PAGE 2.

INDICATES OUTLINE
OF DOOR OPENING.

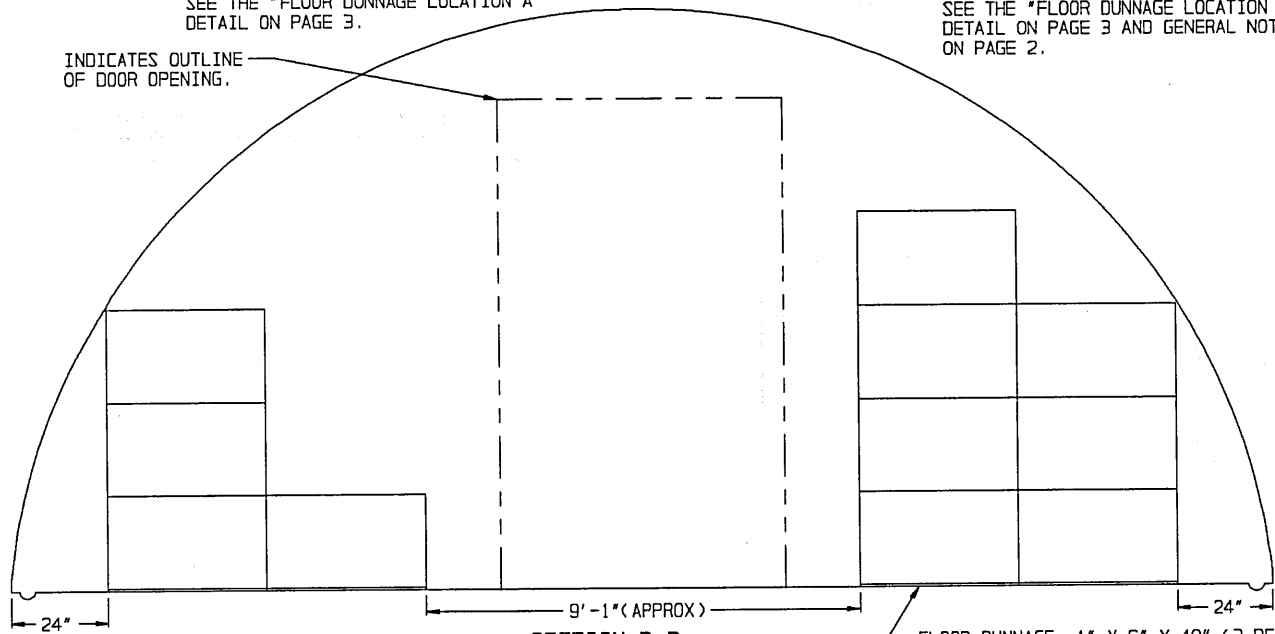

SECTION D-D

FLOOR DUNNAGE, 1" X 6" X 40" (3 REOD PER
FIRST LAYER CONTAINER). SEE THE "FLOOR
DUNNAGE LOCATION A" DETAIL ON PAGE 3.

STORAGE IN 81'-2" MAGAZINE

(12'-1-3/4" HIGH)

ITEM QUANTITY

CONTAINERS - - - - - 192

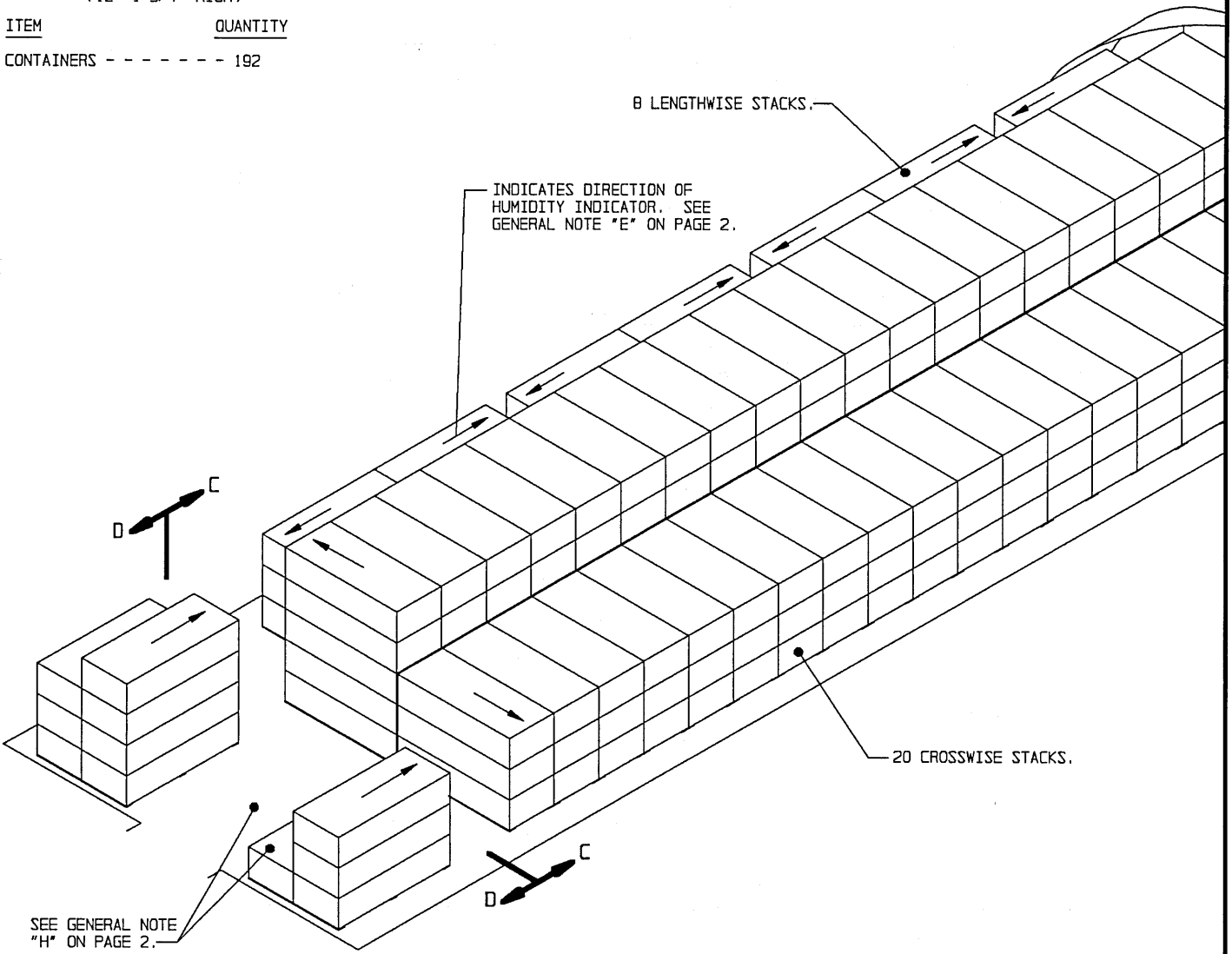

ISOMETRIC VIEW
(81'-2" MAGAZINE)

FOR "GENERAL NOTES" AND "MATERIAL SPECIFICATIONS",
SEE PAGE 2.

BILL OF MATERIAL (PER STACK) *		
TYPE OF STACK	1" X 6" DUNNAGE LUMBER	
	LINEAR FEET	BOARD FEET
LENGTHWISE	10	5
CROSSWISE	16	8

* SEE GENERAL NOTE "G" ON PAGE 2.

STORAGE IN 80'-0" MAGAZINE

(12'-1-3/4" HIGH)

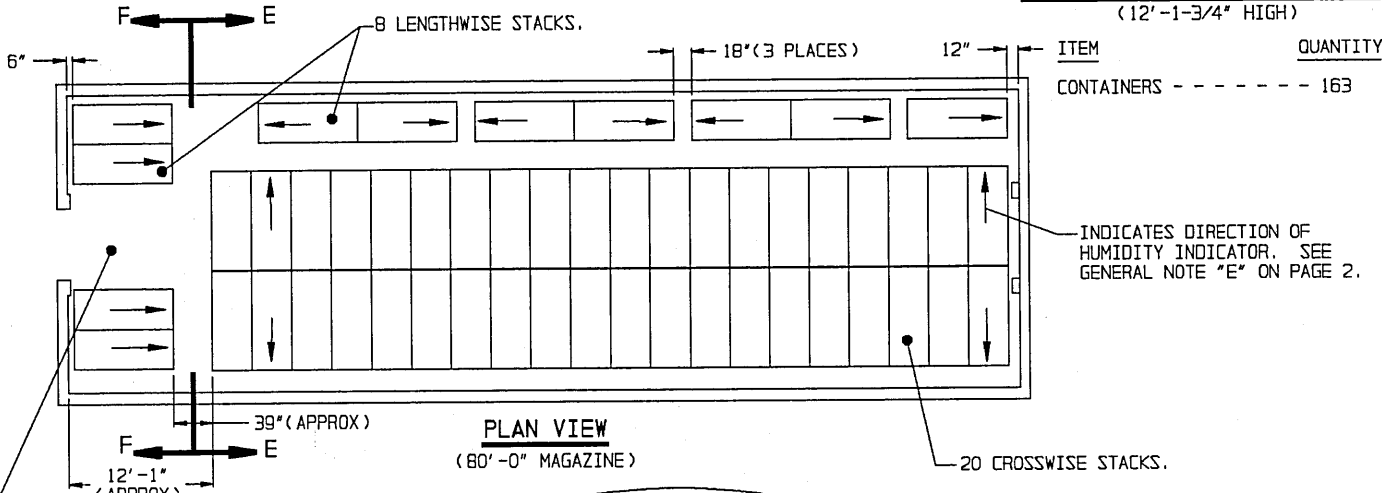

PLAN VIEW
(80'-0" MAGAZINE)

SEE GENERAL NOTE "H" ON PAGE 2.

SEE GENERAL NOTE "J" ON PAGE 2.

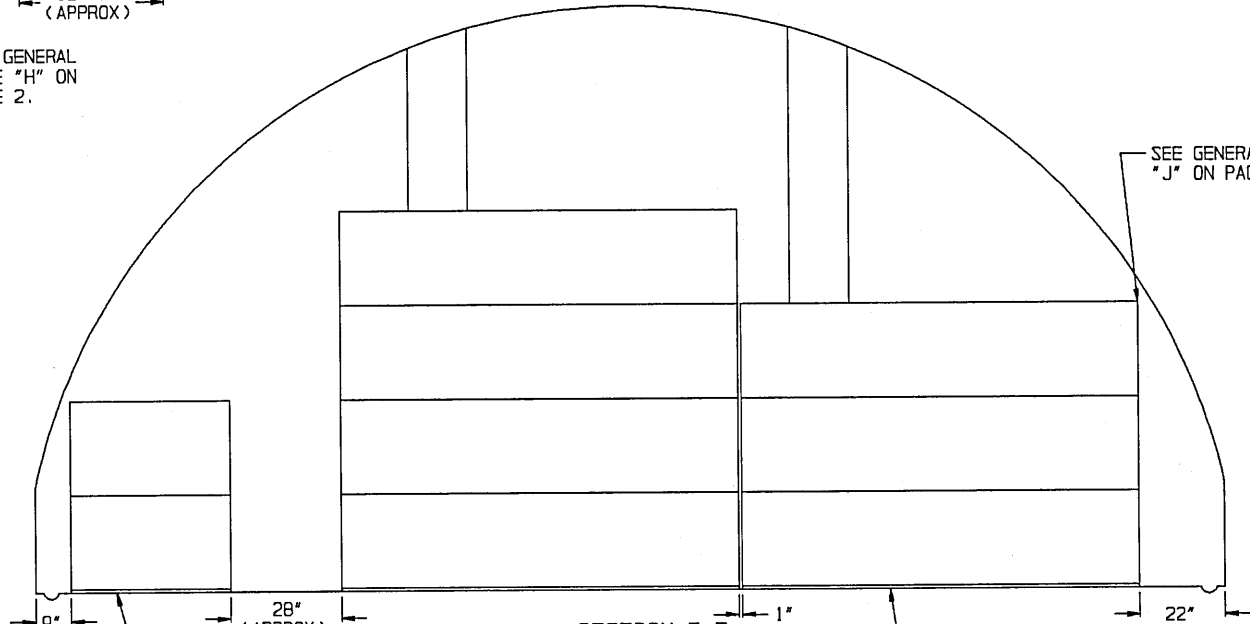

SECTION E-E

FLOOR DUNNAGE, 1" X 6" X 40"
(3 REOD PER FIRST-LAYER CONTAINER).
SEE THE "FLOOR DUNNAGE LOCATION A"
DETAIL ON PAGE 3 AND GENERAL
NOTE "G" ON PAGE 2.

FLOOR DUNNAGE, 1" X 6" X 8'-0"
(2 REOD PER FIRST-LAYER CONTAINER).
SEE THE "FLOOR DUNNAGE LOCATION B"
DETAIL ON PAGE 3.

INDICATES OUTLINE OF DOOR OPENING.

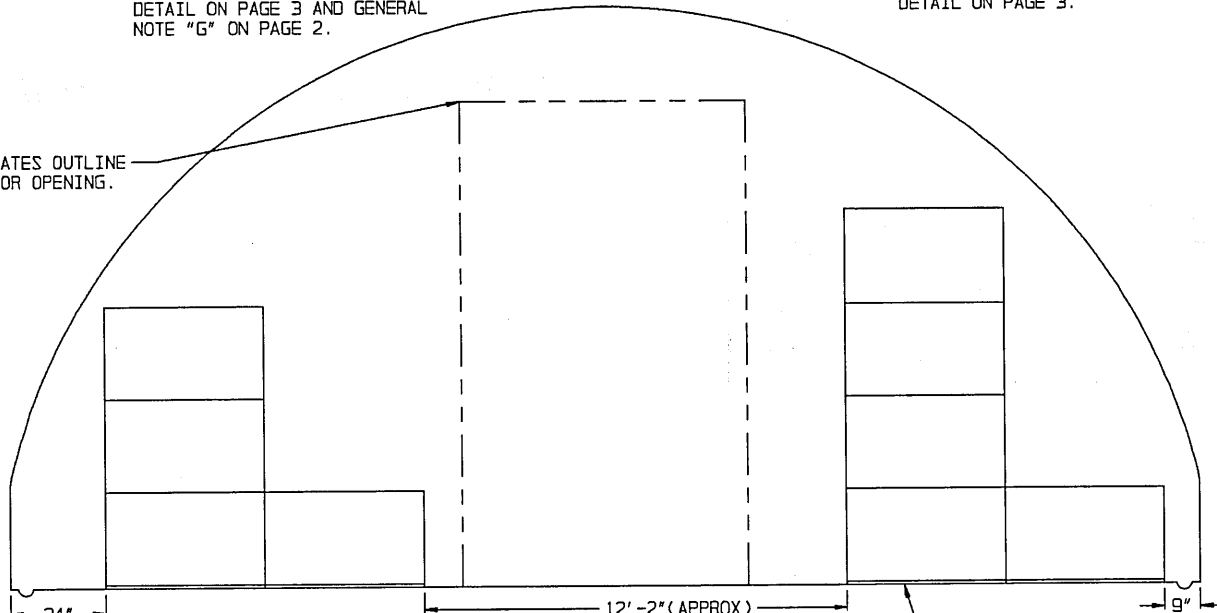

SECTION F-F

SEE "FLOOR DUNNAGE LOCATION A" DETAIL ON PAGE 3.

STORAGE IN 40'-0" MAGAZINE
(12'-1-3/4" HIGH)

ITEM QUANTITY
CONTAINERS - - - - - 71

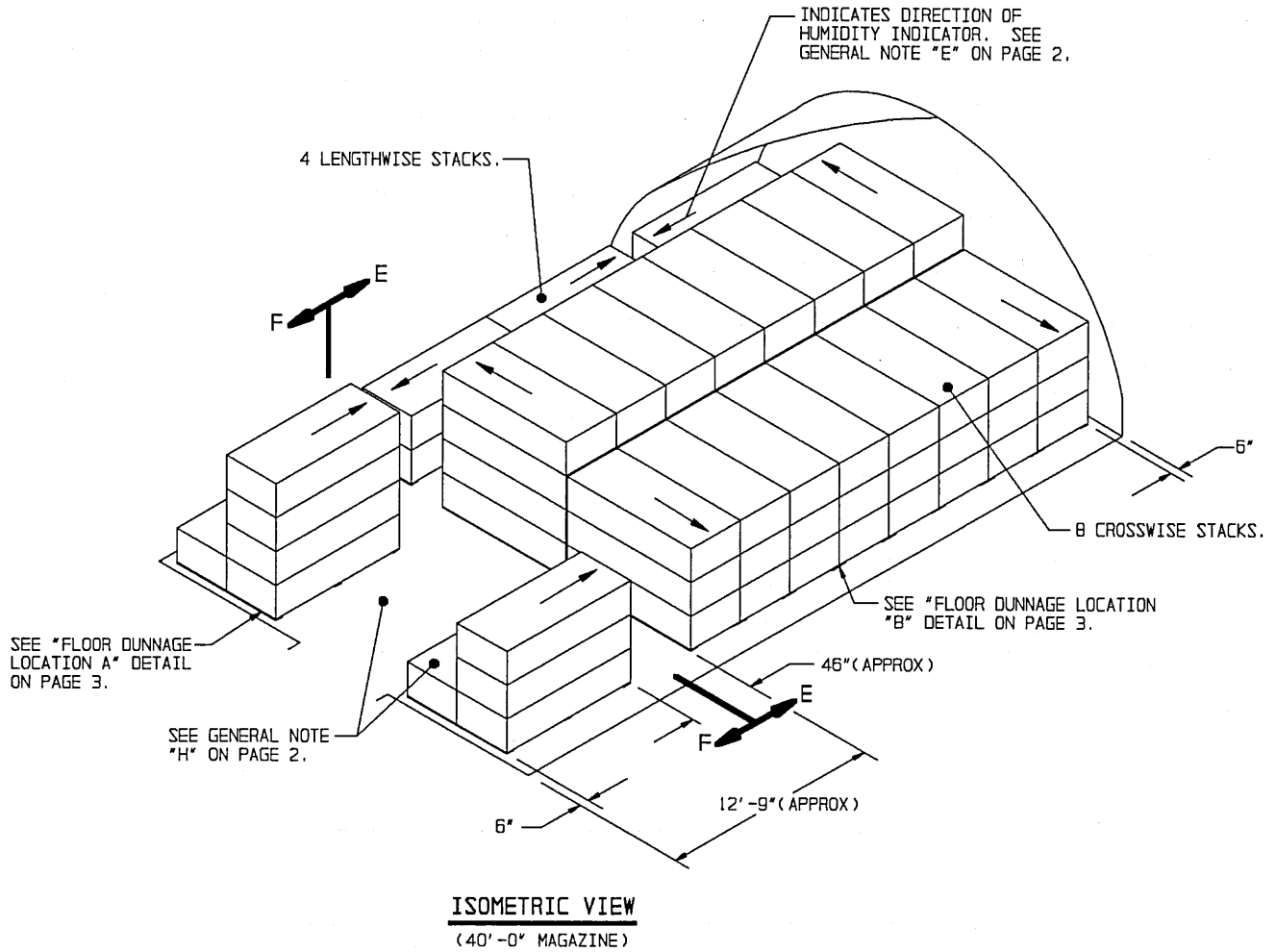

FOR "GENERAL NOTES" AND "MATERIAL SPECIFICATIONS", SEE PAGE 2.

BILL OF MATERIAL (PER STACK) *		
TYPE OF STACK	1" X 6" DUNNAGE LUMBER	
	LINEAR FEET	BOARD FEET
LENGTHWISE	10	5
CROSSWISE	16	8

* SEE GENERAL NOTE "G" ON PAGE 2.

STORAGE IN 80'-0" MAGAZINE
(11'-0" HIGH)

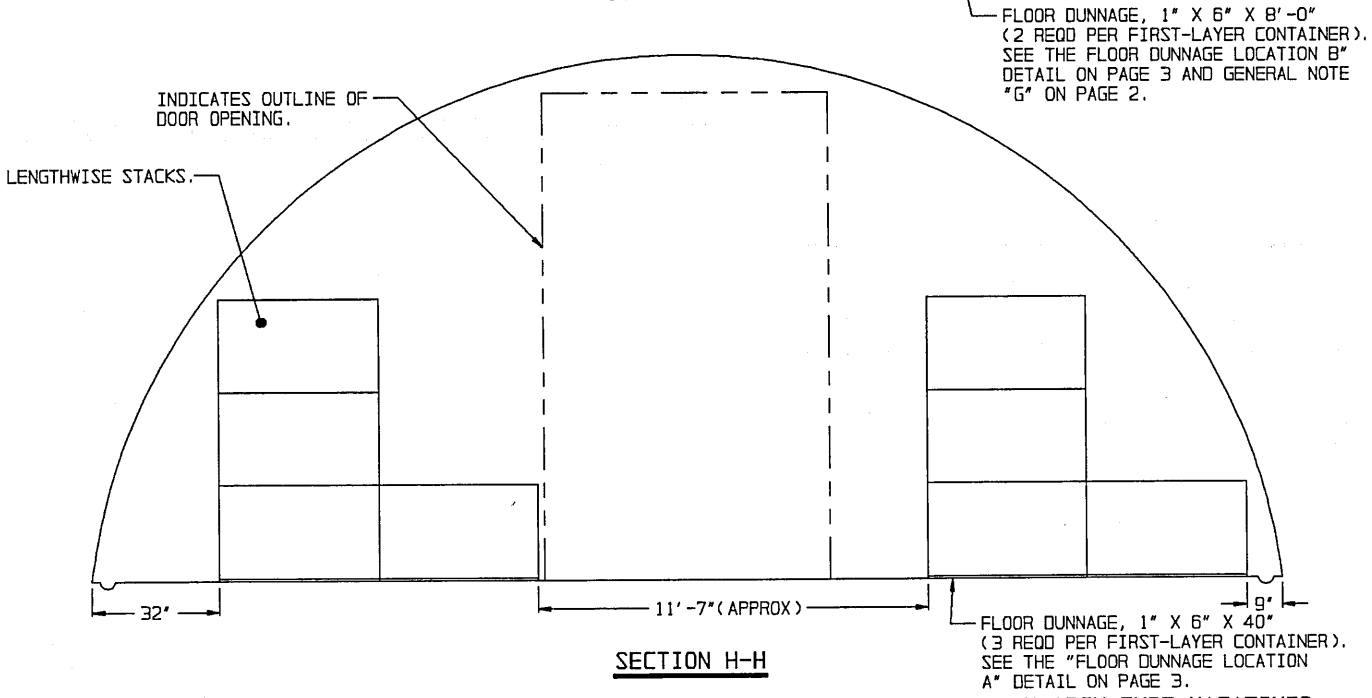
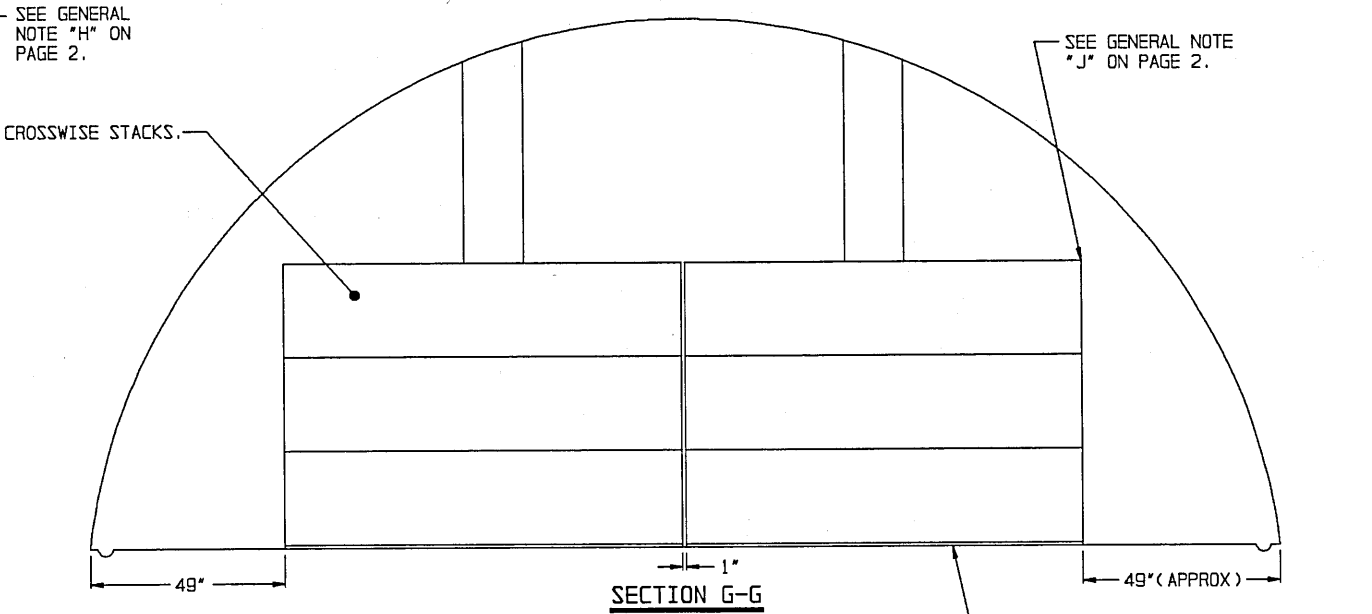
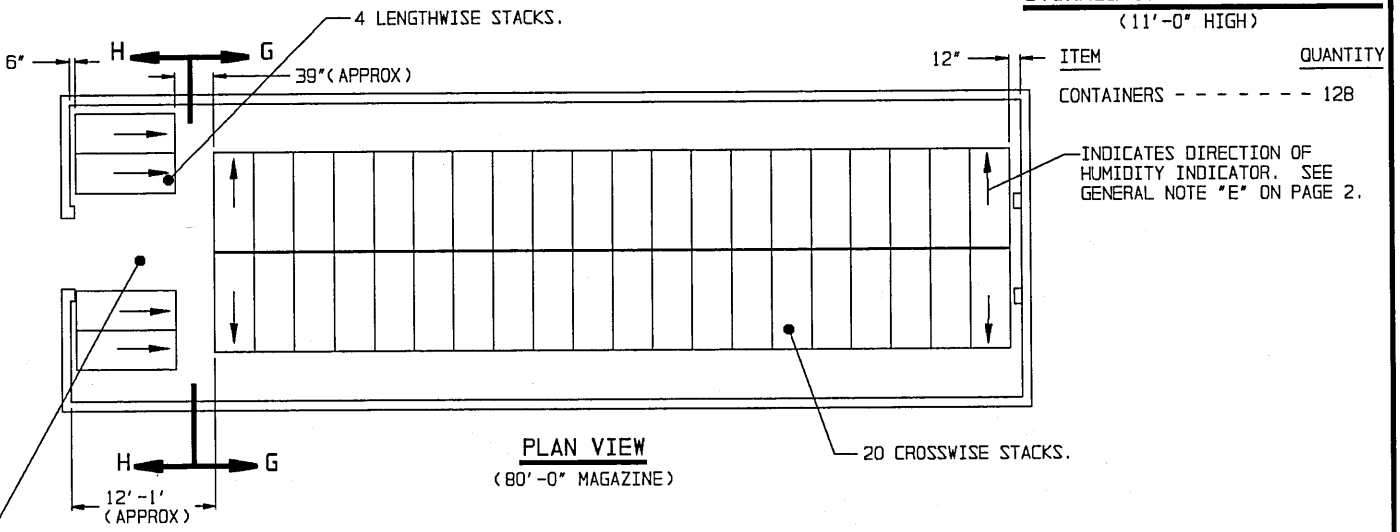

STORAGE IN 40'-0" MAGAZINE

(11'-0" HIGH)

ITEM QUANTITY

CONTAINERS - - - - - 56

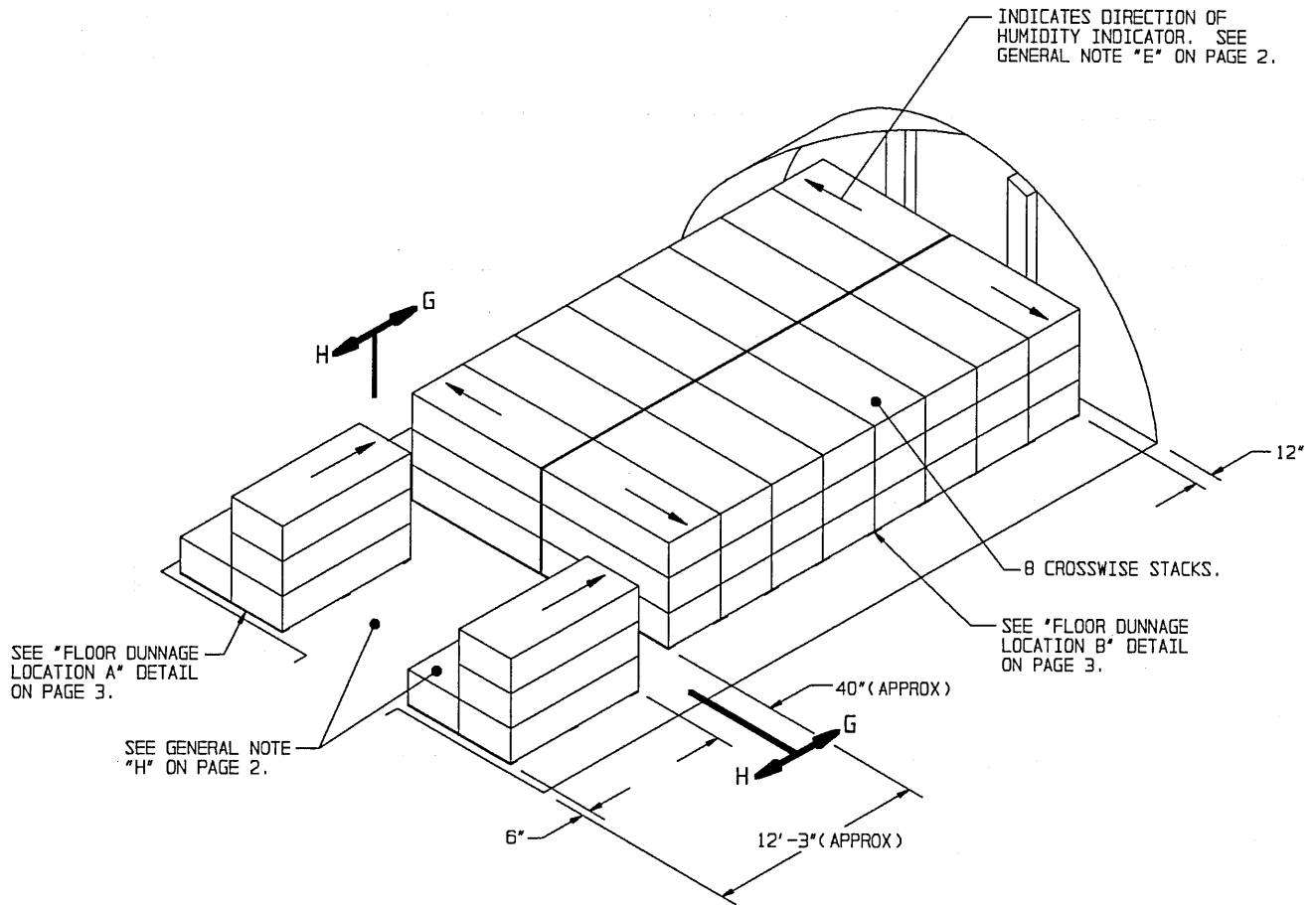

ISOMETRIC VIEW

(40'-0" MAGAZINE)

FOR "GENERAL NOTES" AND "MATERIAL SPECIFICATIONS" SEE PAGE 2.

BILL OF MATERIAL (PER STACK) *		
TYPE OF STACK	1" X 6" DUNNAGE LUMBER	
	LINEAR FEET	BOARD FEET
LENGTHWISE	10	5
CROSSWISE	16	8

* SEE GENERAL NOTE "G" ON PAGE 2.

STORAGE IN 80'-0" MAGAZINE
(10'-0" HIGH)

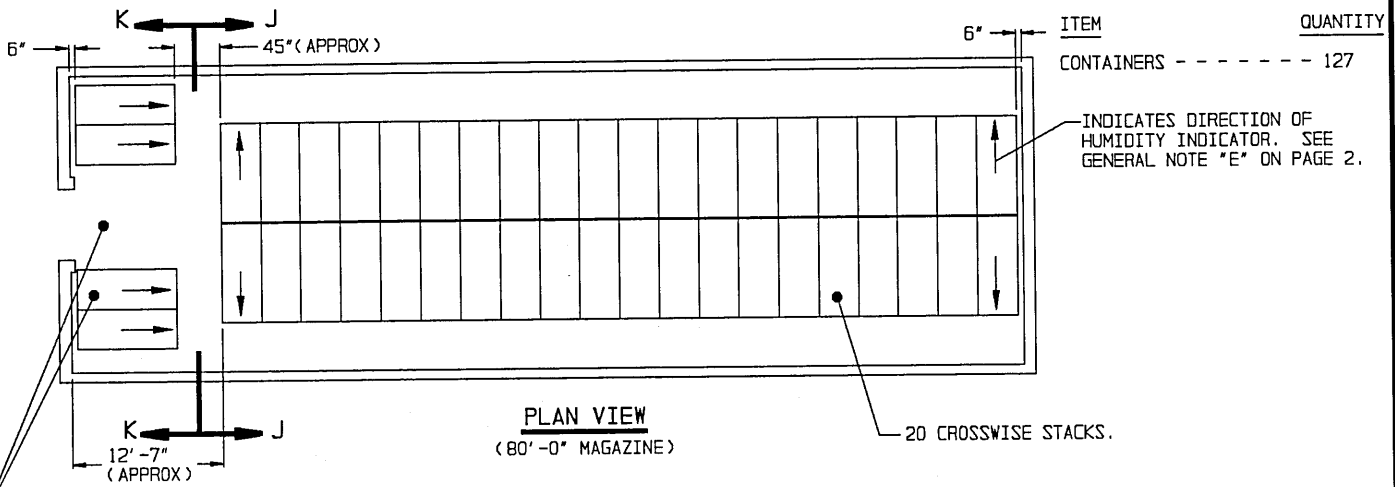

SEE GENERAL NOTE "H" ON PAGE 2.

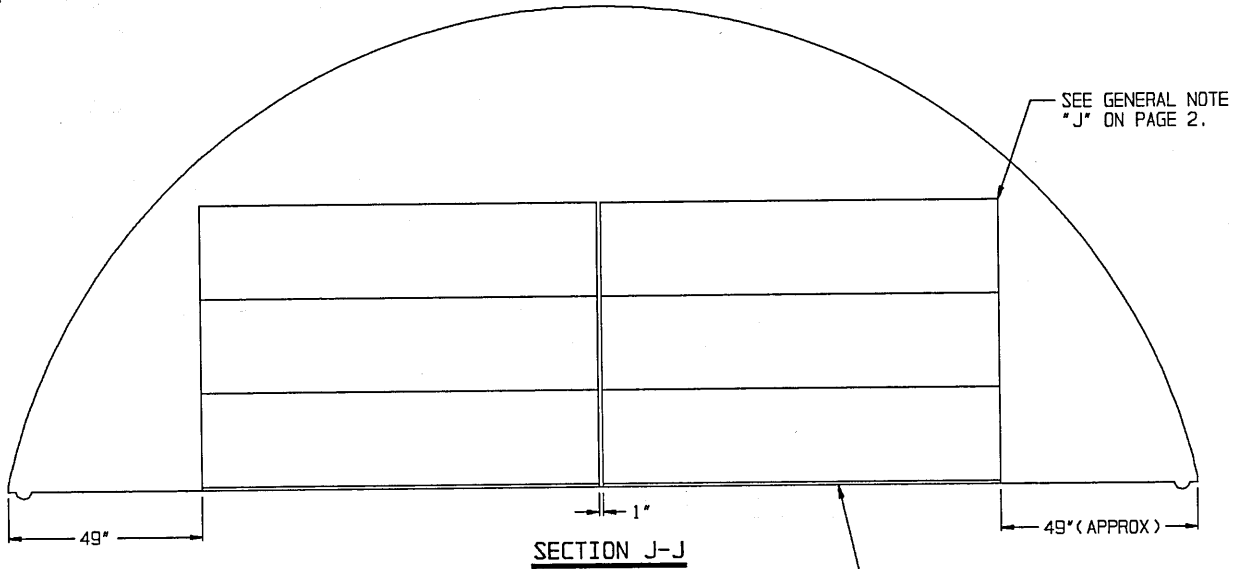

FLOOR DUNNAGE, 1" X 6" X 8'-0"
(2 REED PER FIRST-LAYER CONTAINER).
SEE THE "FLOOR DUNNAGE LOCATION B"
DETAIL ON PAGE 3 AND GENERAL NOTE
"G" ON PAGE 2.

INDICATES OUTLINE OF DOOR OPENING.

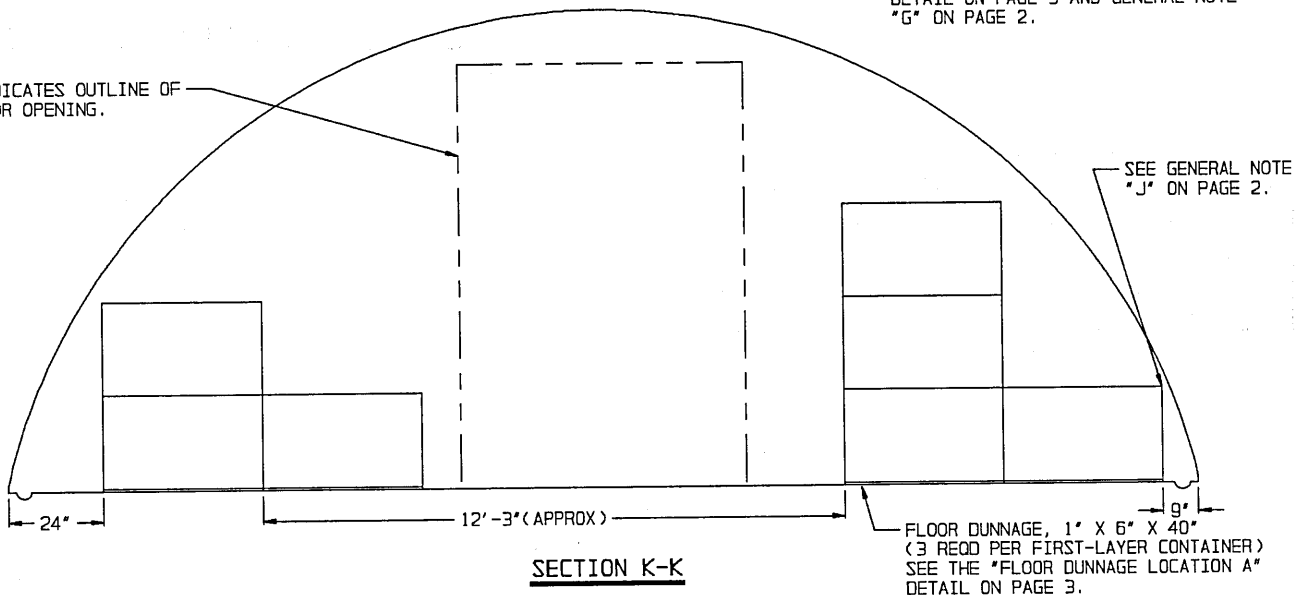

FLOOR DUNNAGE, 1" X 6" X 40"
(3 REED PER FIRST-LAYER CONTAINER)
SEE THE "FLOOR DUNNAGE LOCATION A"
DETAIL ON PAGE 3.

STORAGE IN 40'-0" MAGAZINE
(10'-0" HIGH)

ITEM	QUANTITY
CONTAINERS - - - - -	55

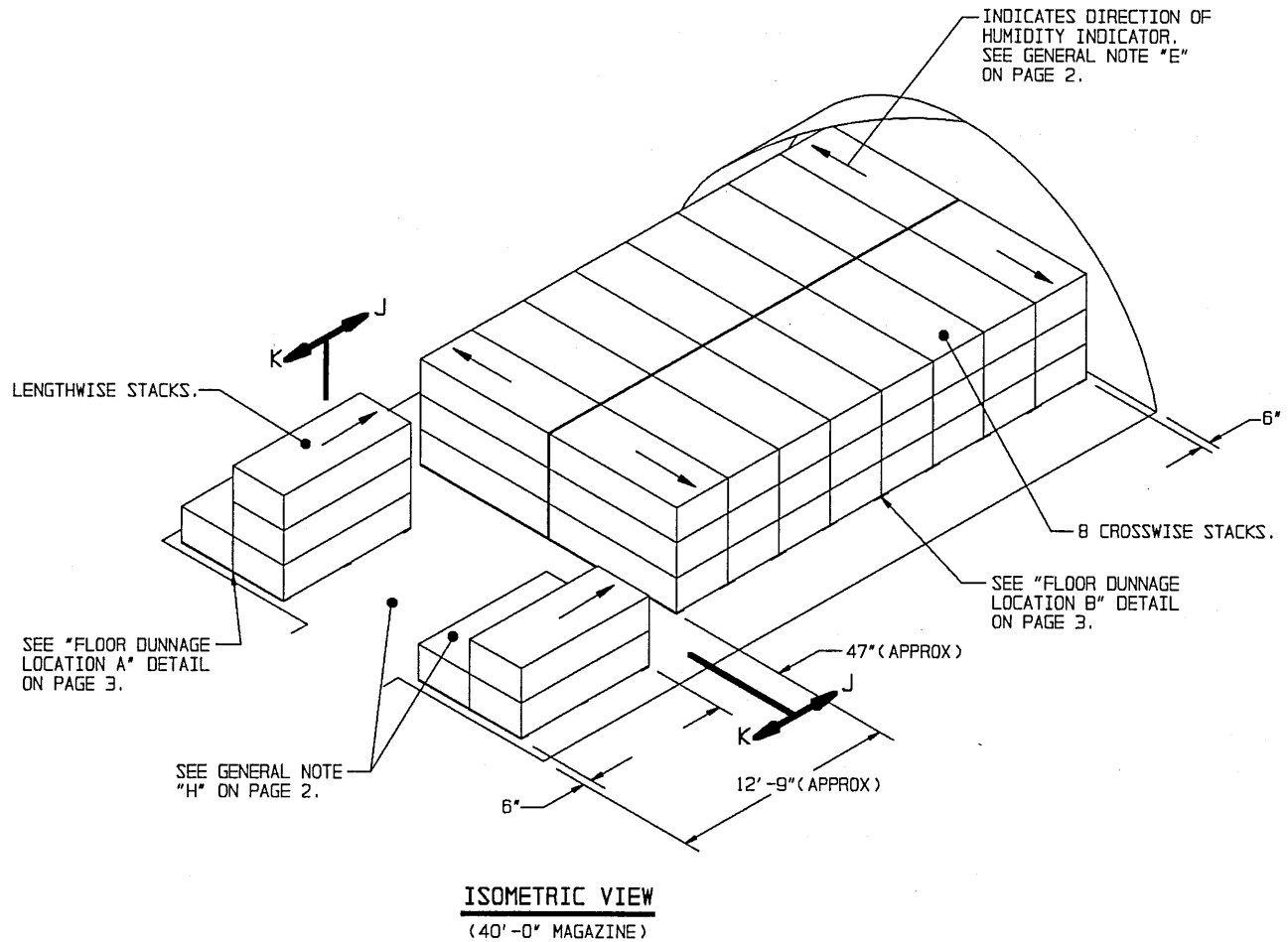

FOR "GENERAL NOTES" AND "MATERIAL SPECIFICATIONS", SEE PAGE 2.

BILL OF MATERIAL (PER STACK) *		
TYPE OF STACK	1" X 6" DUNNAGE LUMBER	
	LINEAR FEET	BOARD FEET
LENGTHWISE	10	5
CROSSWISE	16	8

* SEE GENERAL NOTE "G" ON PAGE 2.

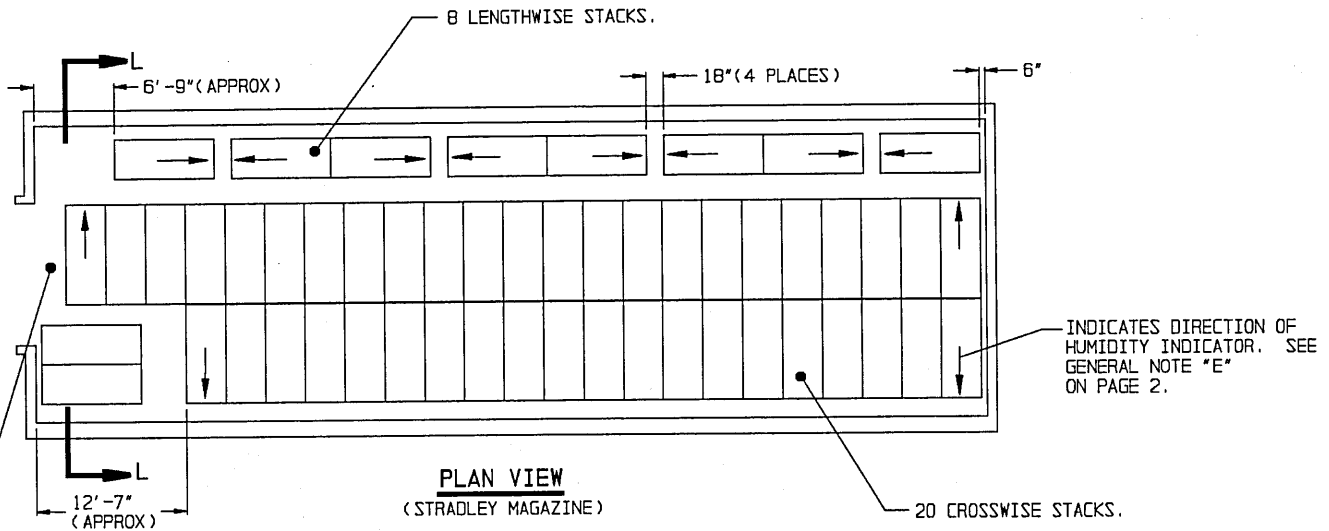

SEE GENERAL NOTE "H" ON PAGE 2.

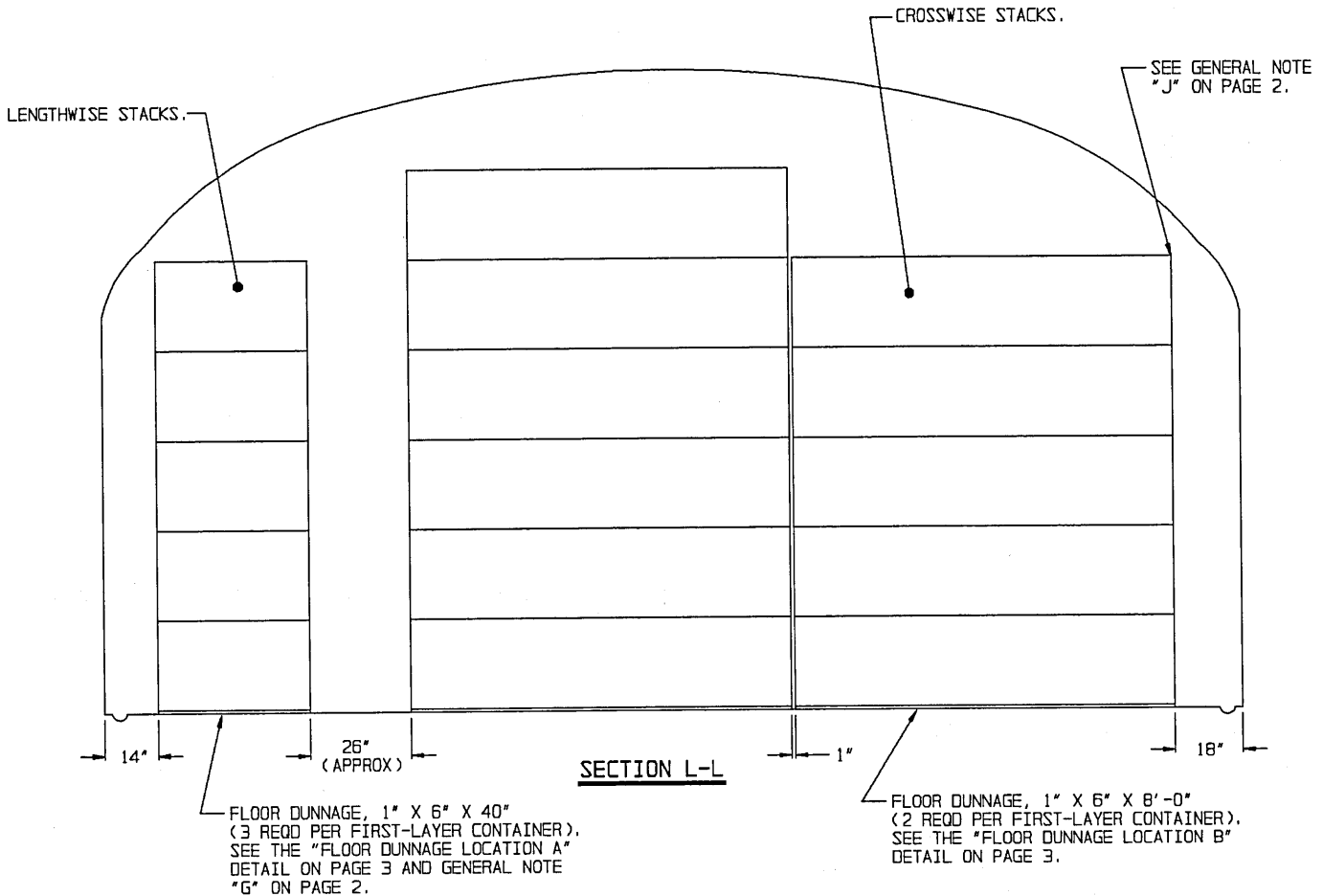

STORAGE IN STRADLEY MAGAZINE

(14'-0" HIGH)

ITEM QUANTITY

CONTAINERS - - - - - 284

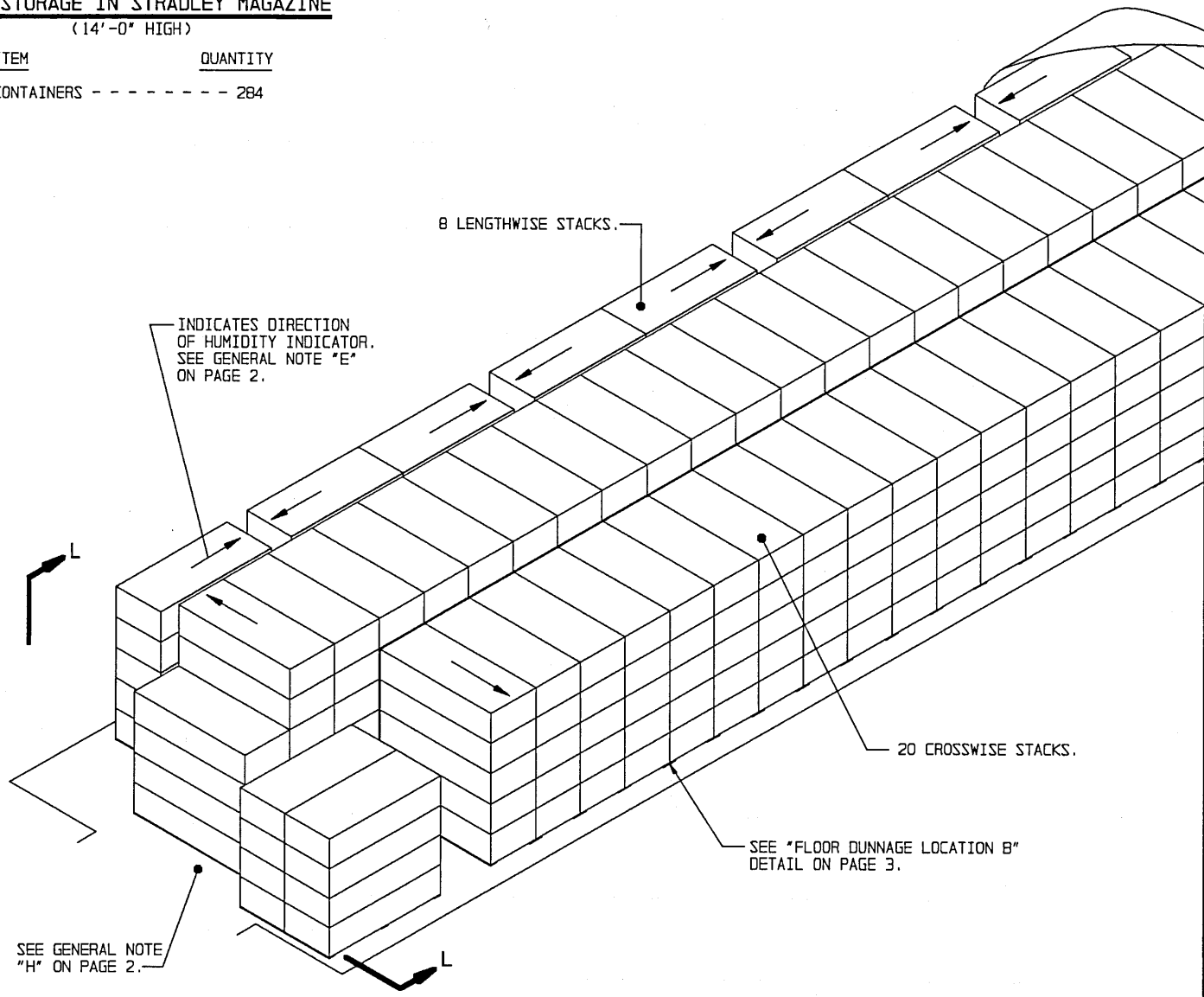

ISOMETRIC VIEW
(STRADLEY MAGAZINE)

FOR "GENERAL NOTES" AND "MATERIAL SPECIFICATIONS", SEE PAGE 2.

BILL OF MATERIAL (PER STACK) *		
TYPE OF STACK	1" X 6" DUNNAGE LUMBER	
	LINEAR FEET	BOARD FEET
LENGTHWISE	10	5
CROSSWISE	16	8

* SEE GENERAL NOTE "G" ON PAGE 2.

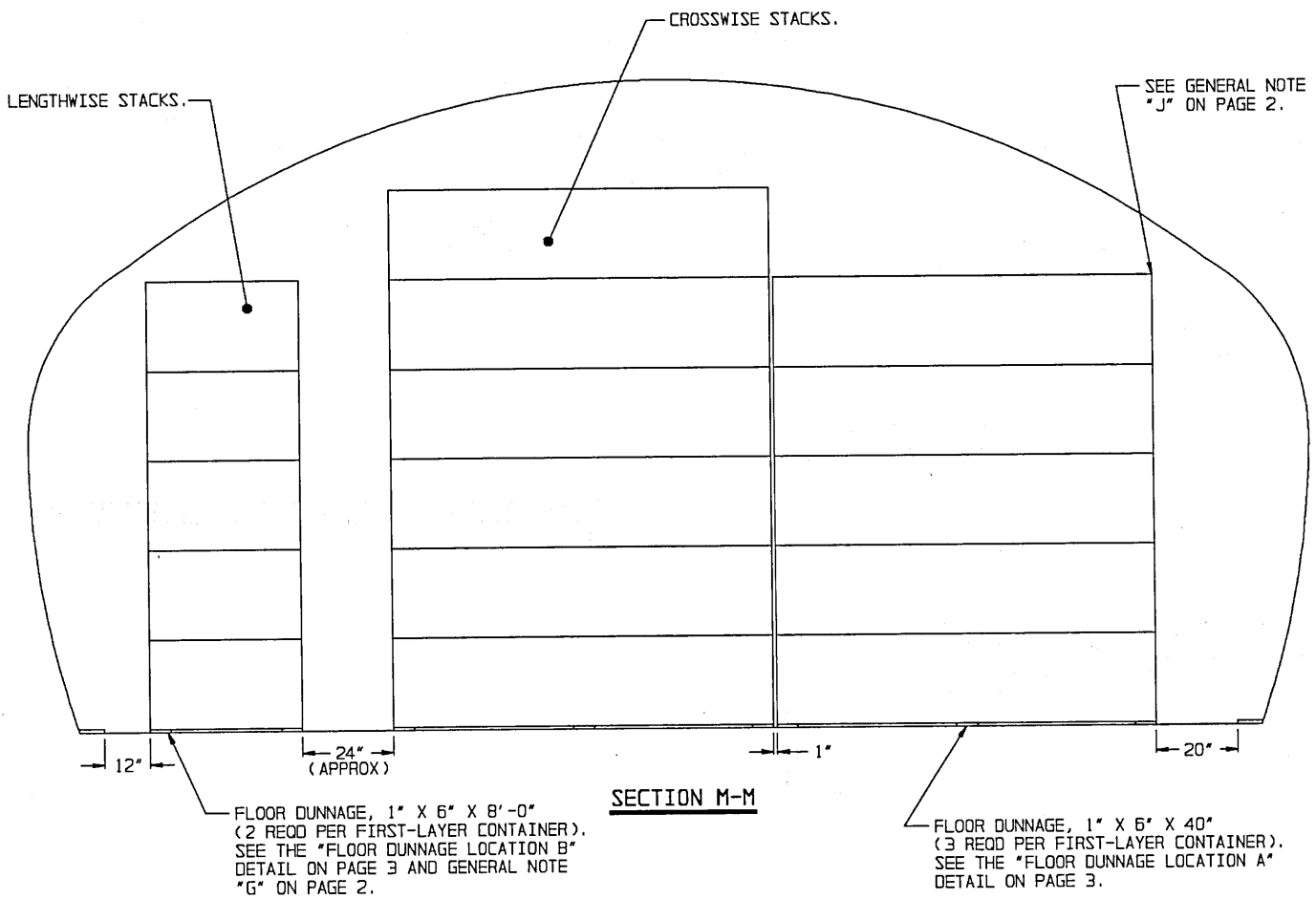
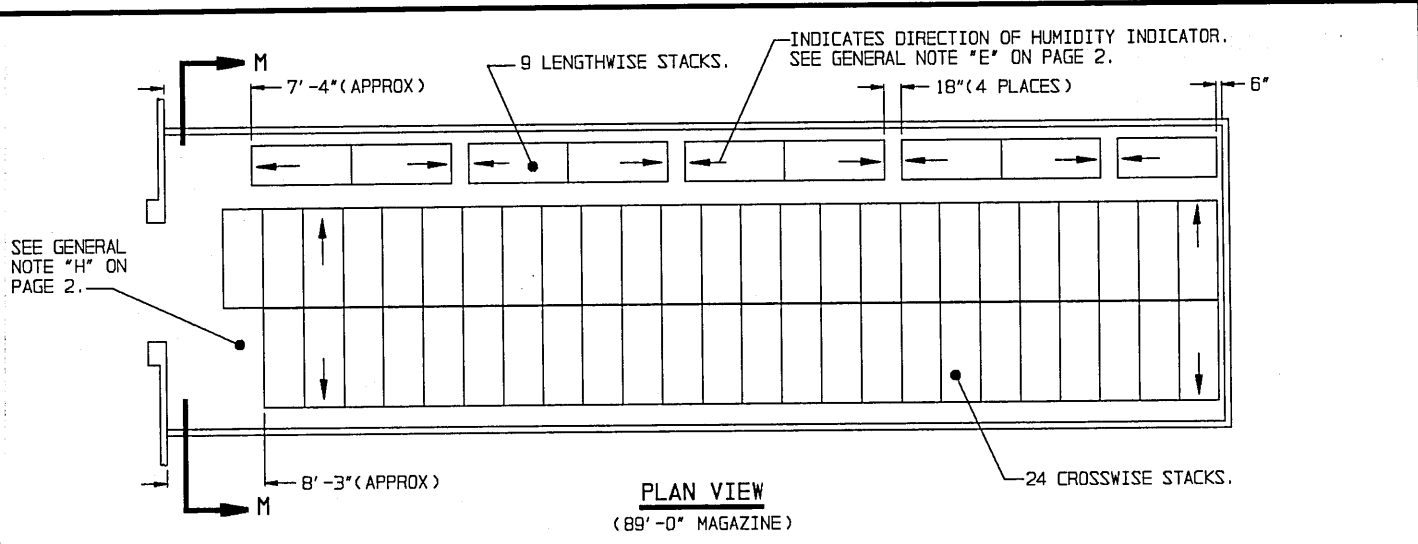

STORAGE IN OVAL ARCH MAGAZINE

(14'-4" HIGH)

ITEM QUANTITY
CONTAINERS - - - - - 306

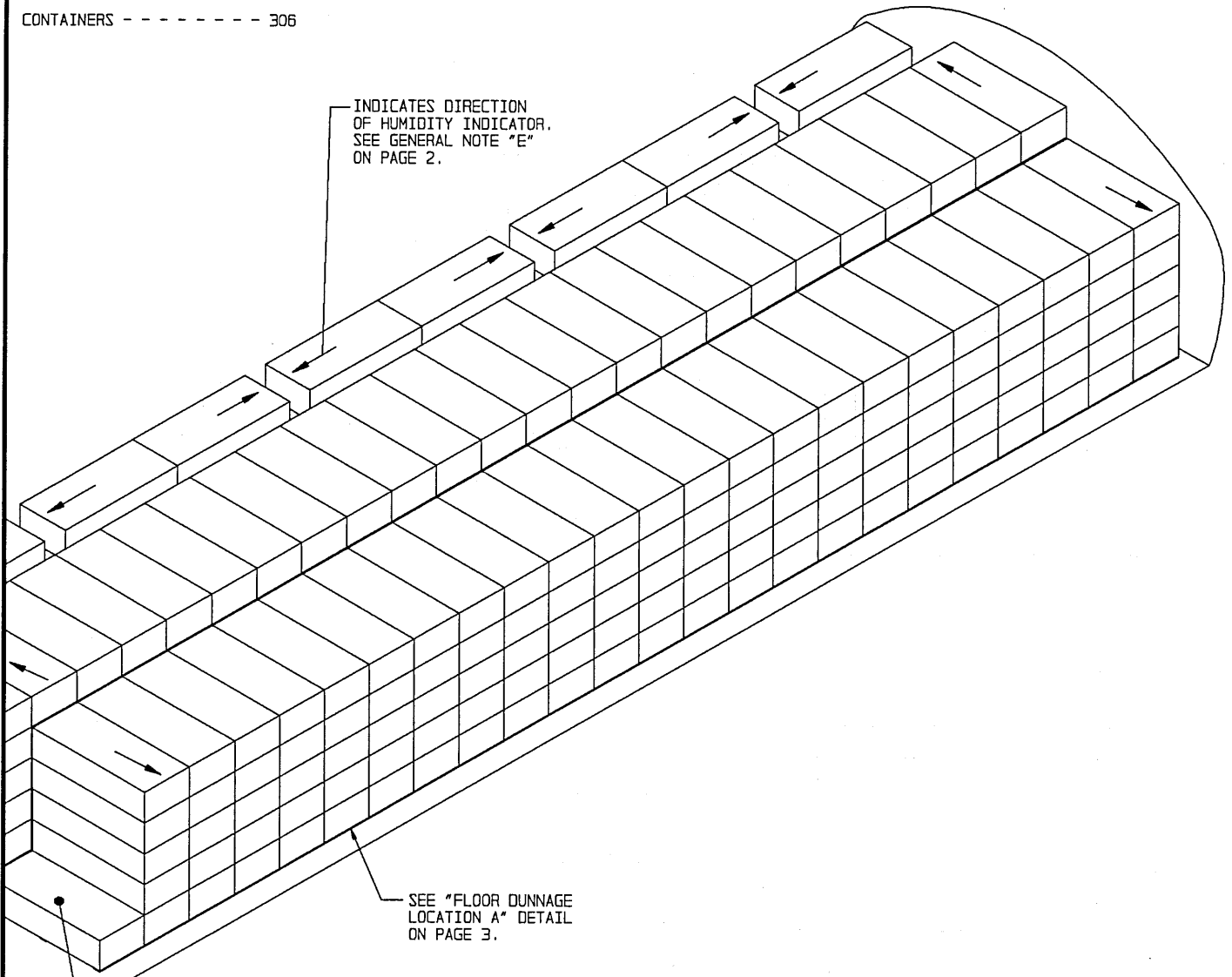

ISOMETRIC VIEW
(89'-0" MAGAZINE)

FOR "GENERAL NOTES" AND "MATERIAL SPECIFICATIONS",
SEE PAGE 2.

BILL OF MATERIAL (PER STACK) *		
TYPE OF STACK	1" X 6" DUNNAGE LUMBER	
	LINEAR FEET	BOARD FEET
LENGTHWISE	10	5
CROSSWISE	16	8

* SEE GENERAL NOTE "G" ON PAGE 2.

SEE GENERAL NOTE
"J" ON PAGE 2.

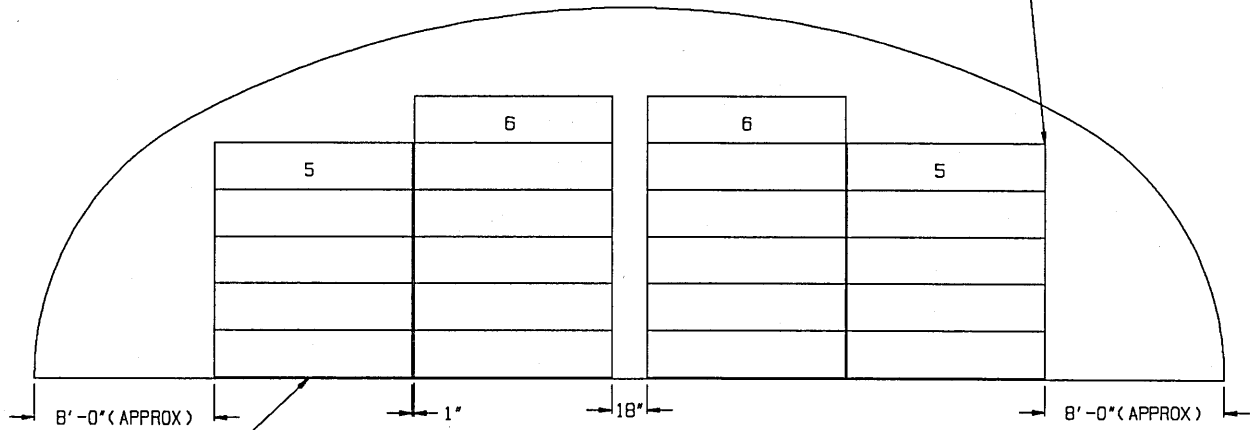

SECTION O-O

FLOOR DUNNAGE, 1" X 6" X 40"
(3 REQD PER FIRST-LAYER CONTAINER).
SEE THE "FLOOR DUNNAGE LOCATION A"
DETAIL ON PAGE 3 AND GENERAL NOTE
"G" ON PAGE 2.

ONLY ONE OF THE ROWS OF
CONTAINERS IS SHOWN IN THIS
SECTION. UNITS LOCATED IN
ADJACENT ROWS OR STACKS
HAVE NOT BEEN SHOWN FOR
CLARITY PURPOSES.

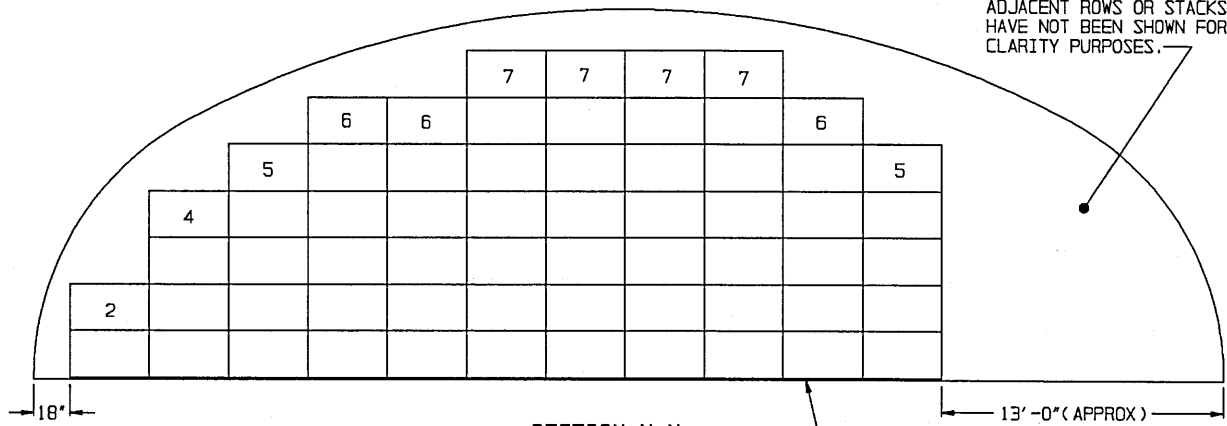

SECTION N-N

FLOOR DUNNAGE, 1" X 6" X 40"
(3 REQD PER FIRST-LAYER CONTAINER).

BILL OF MATERIAL (PER STACK) *		
LUMBER	LINEAR FEET	BOARD FEET
1" X 6"	10	5

* SEE GENERAL NOTE "G" ON PAGE 2.

FOR "GENERAL NOTES" AND "MATERIAL SPECIFICATIONS",
SEE PAGE 2.

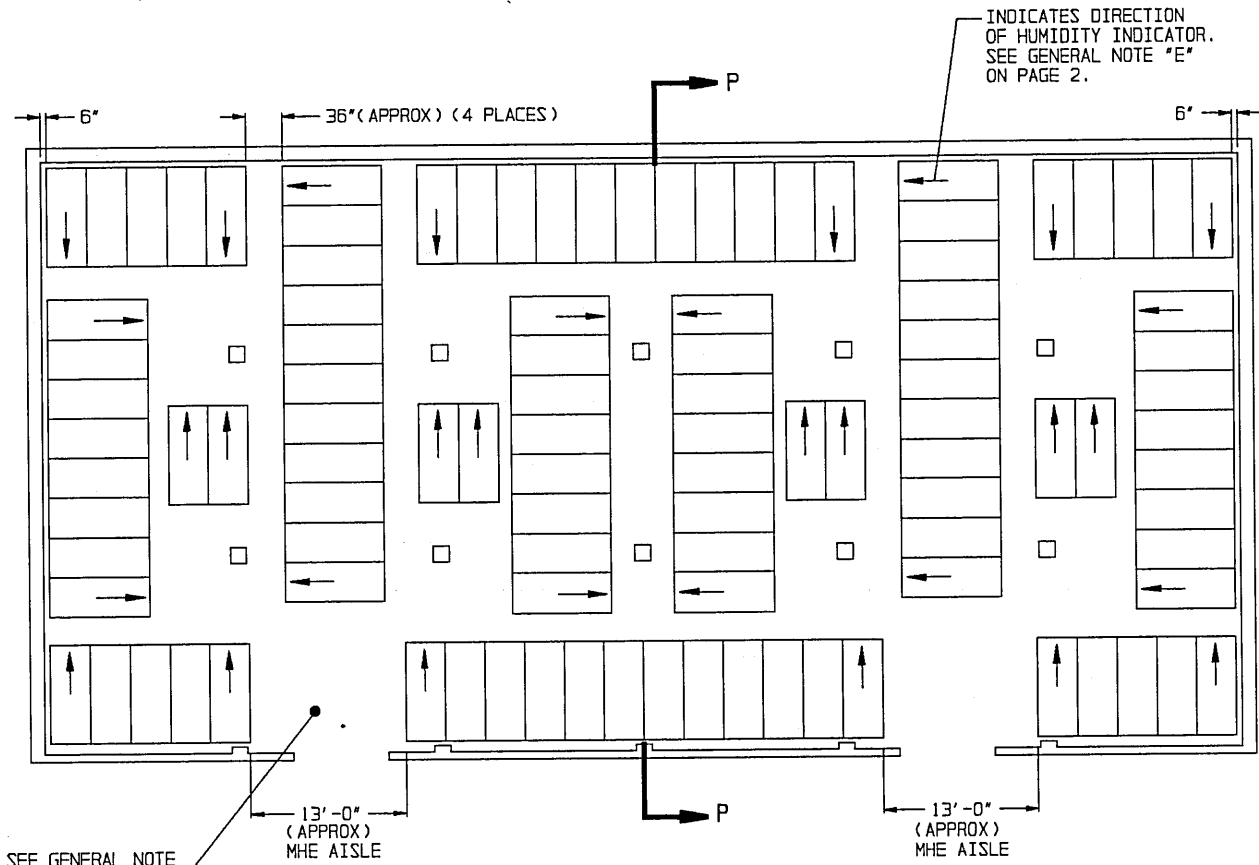

PLAN VIEW
(100'-8" X 50'-0" MAGAZINE)

CONTAINERS IN TOP LAYER WILL BE OMITTED AS REQUIRED TO CLEAR ROOF SUPPORT CAPS AT TOP OF COLUMNS.

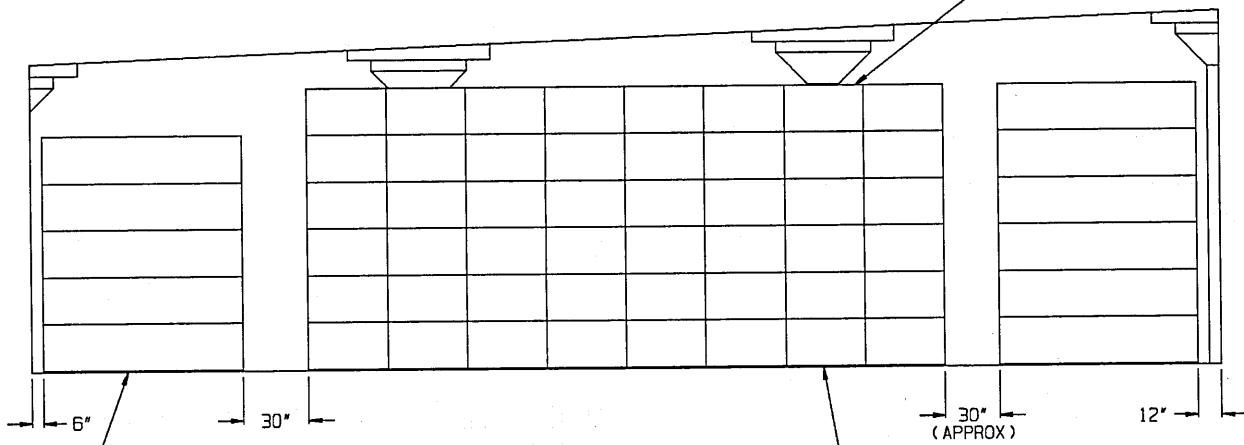

SECTION P-P

FLOOR DUNNAGE, 1" X 6" X 8'-0"
(2 REQD PER FIRST-LAYER CONTAINER).
SEE THE "FLOOR DUNNAGE LOCATION B"
DETAIL ON PAGE 3.

FLOOR DUNNAGE, 1" X 6" X 40"
(3 REQD PER FIRST-LAYER CONTAINER).
SEE THE "FLOOR DUNNAGE LOCATION A"
DETAIL ON PAGE 3 AND GENERAL NOTE
"G" ON PAGE 2.

STORAGE IN 100'-8" X 50'-0" MAGAZINE

ITEM QUANTITY
CONTAINERS - - - - - 603

INDICATES DIRECTION OF HUMIDITY INDICATOR. SEE GENERAL NOTE "E" ON PAGE 2.

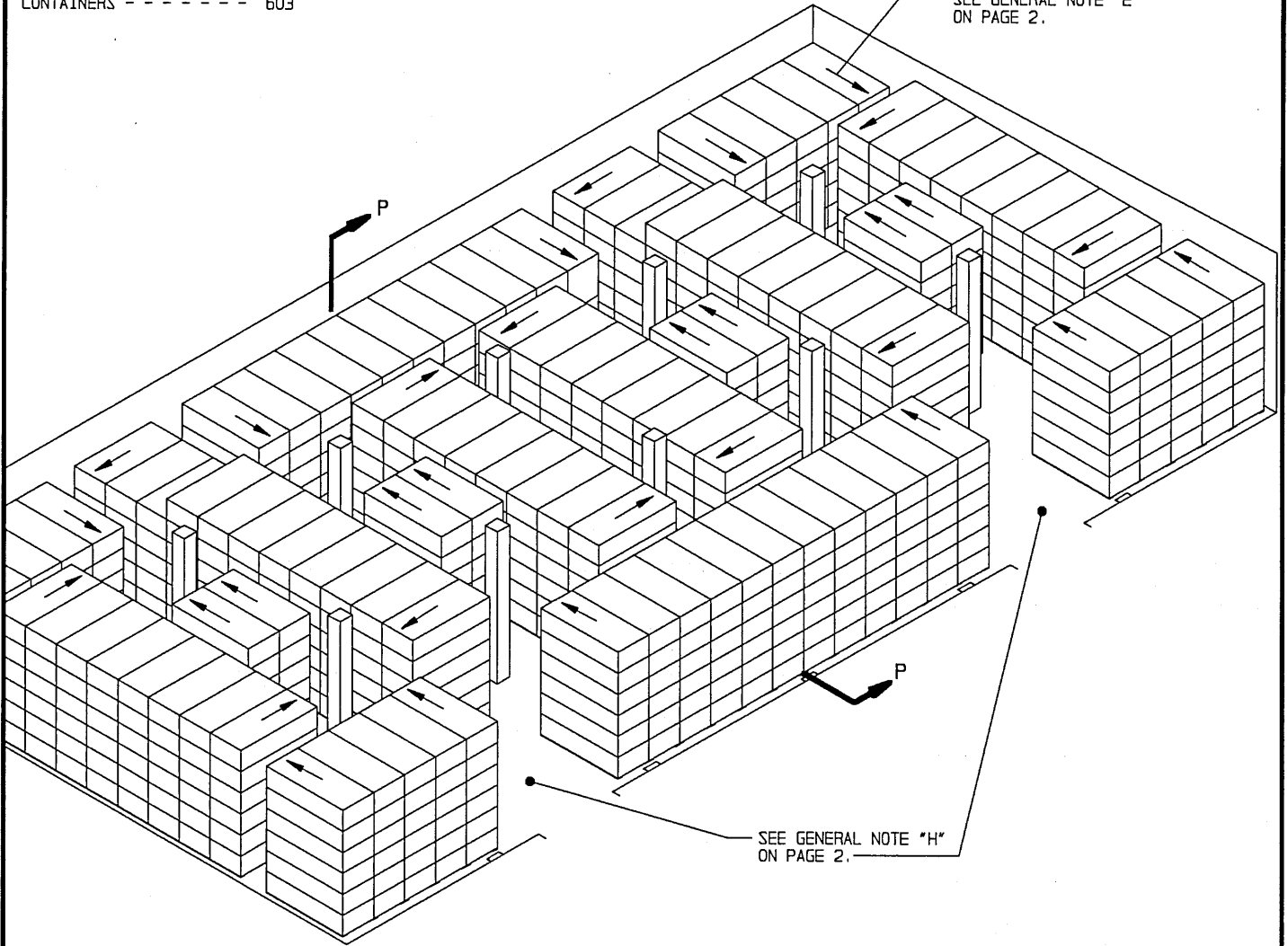

ISOMETRIC VIEW
(100'-8" X 50'-0" MAGAZINE)

BILL OF MATERIAL (PER STACK) *		
TYPE OF STACK	1" X 6" DUNNAGE LUMBER	
	LINEAR FEET	BOARD FEET
LENGTHWISE	10	5
CROSSWISE	16	8

* SEE GENERAL NOTE "G" ON PAGE 2.

FOR "GENERAL NOTES" AND "MATERIAL SPECIFICATIONS", SEE PAGE 2.

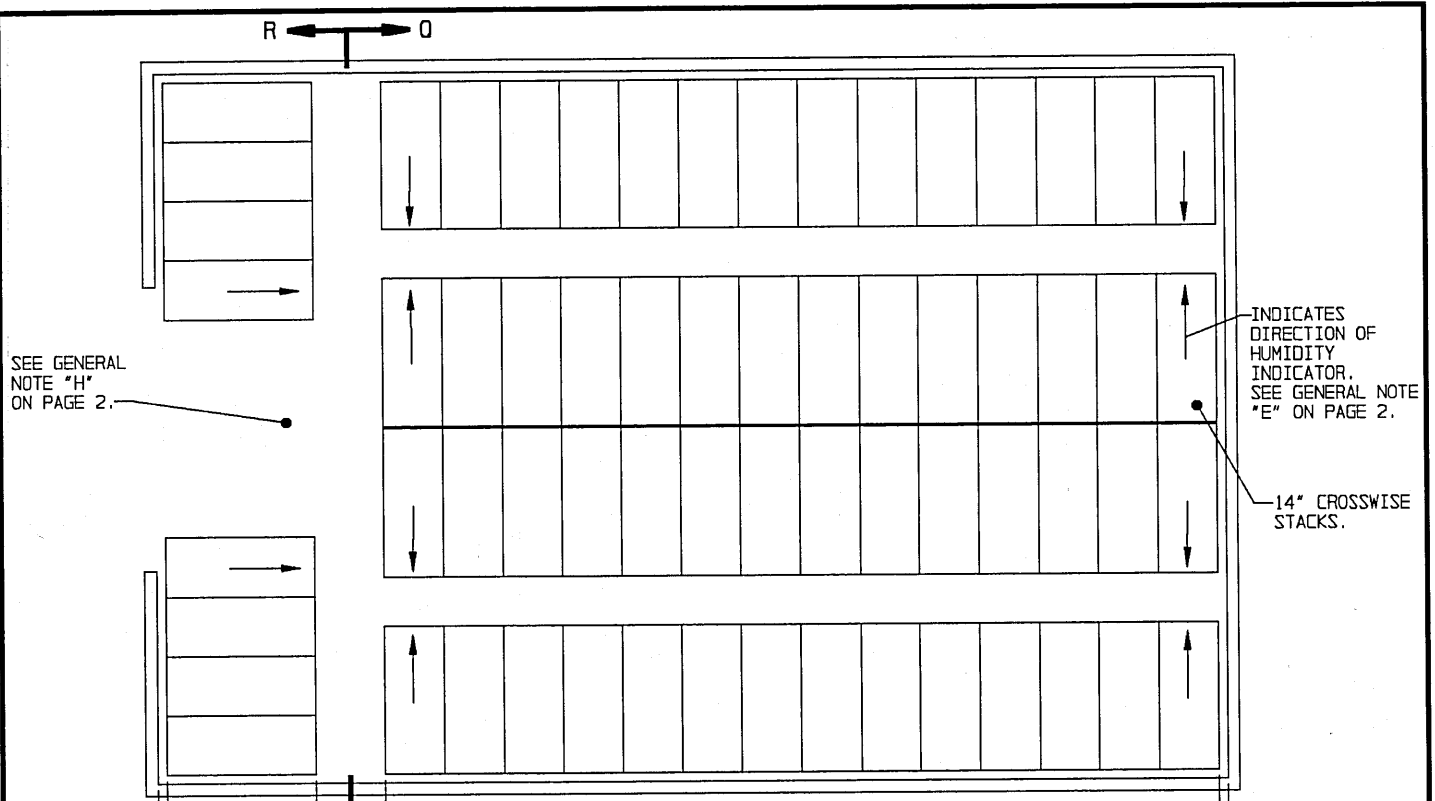

PLAN VIEW
(TYPE II BUNKER)

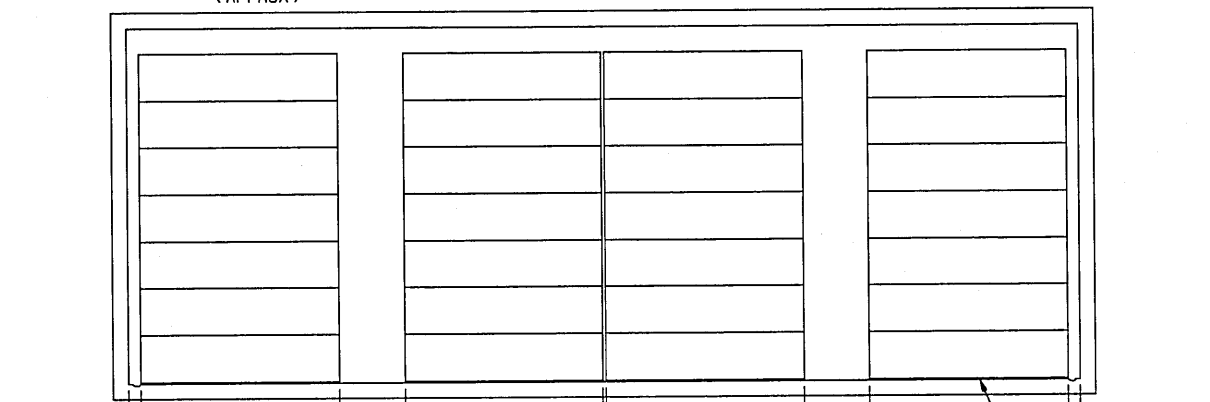

SECTION O-O

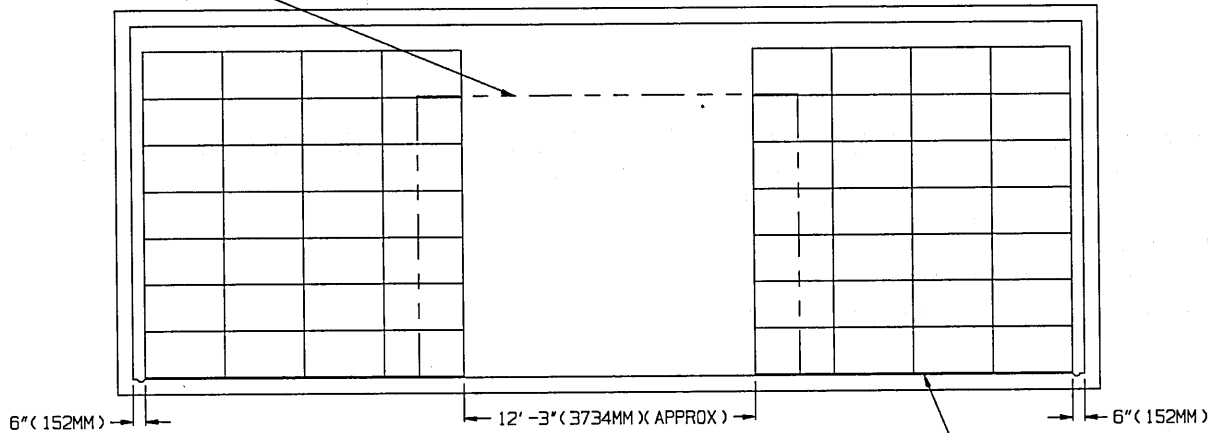

SECTION R-R

STORAGE PROCEDURES IN 60'-0" L X 40'-0" W X 15'-0" H TYPE II BUNKER

STORAGE IN TYPE II BUNKER

ITEM	QUANTITY
CONTAINERS - - - - -	448

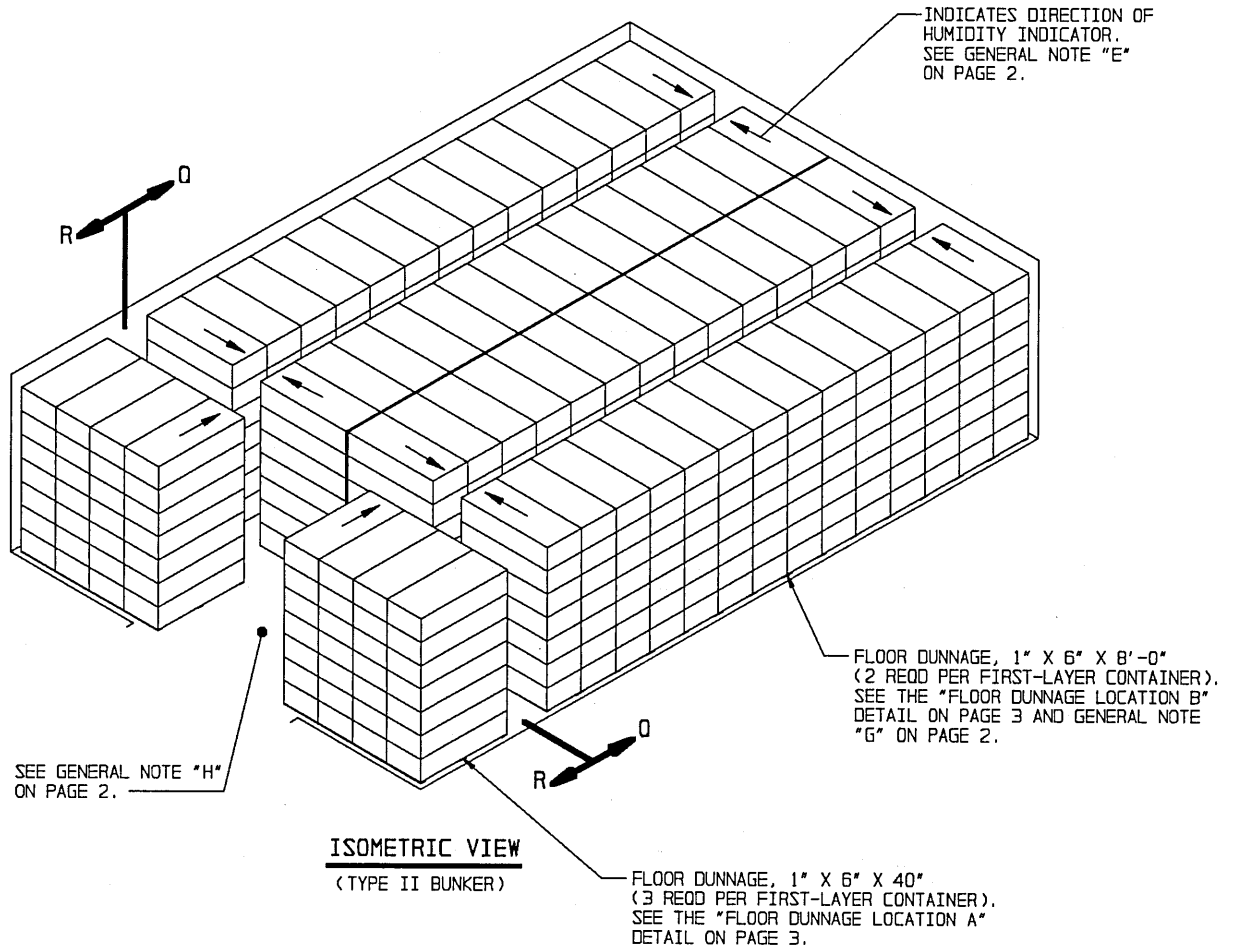

BILL OF MATERIAL (PER STACK) *		
TYPE OF STACK	1" X 6" DUNNAGE LUMBER	
	LINEAR FEET	BOARD FEET
LENGTHWISE	10	5
CROSSWISE	16	8

* SEE GENERAL NOTE "G" ON PAGE 2.

FOR "GENERAL NOTES" AND "MATERIAL SPECIFICATIONS" SEE PAGE 2.

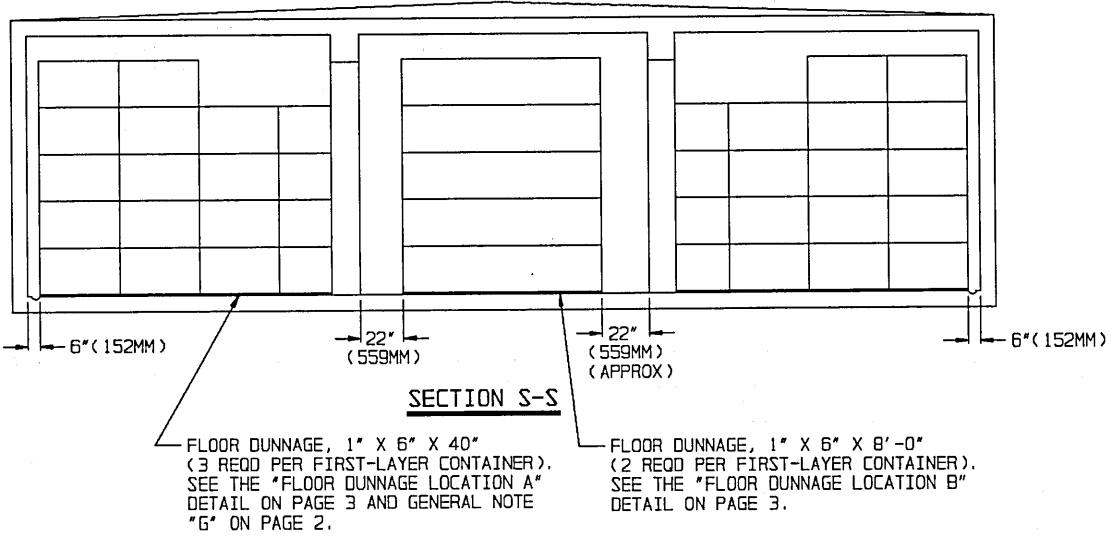
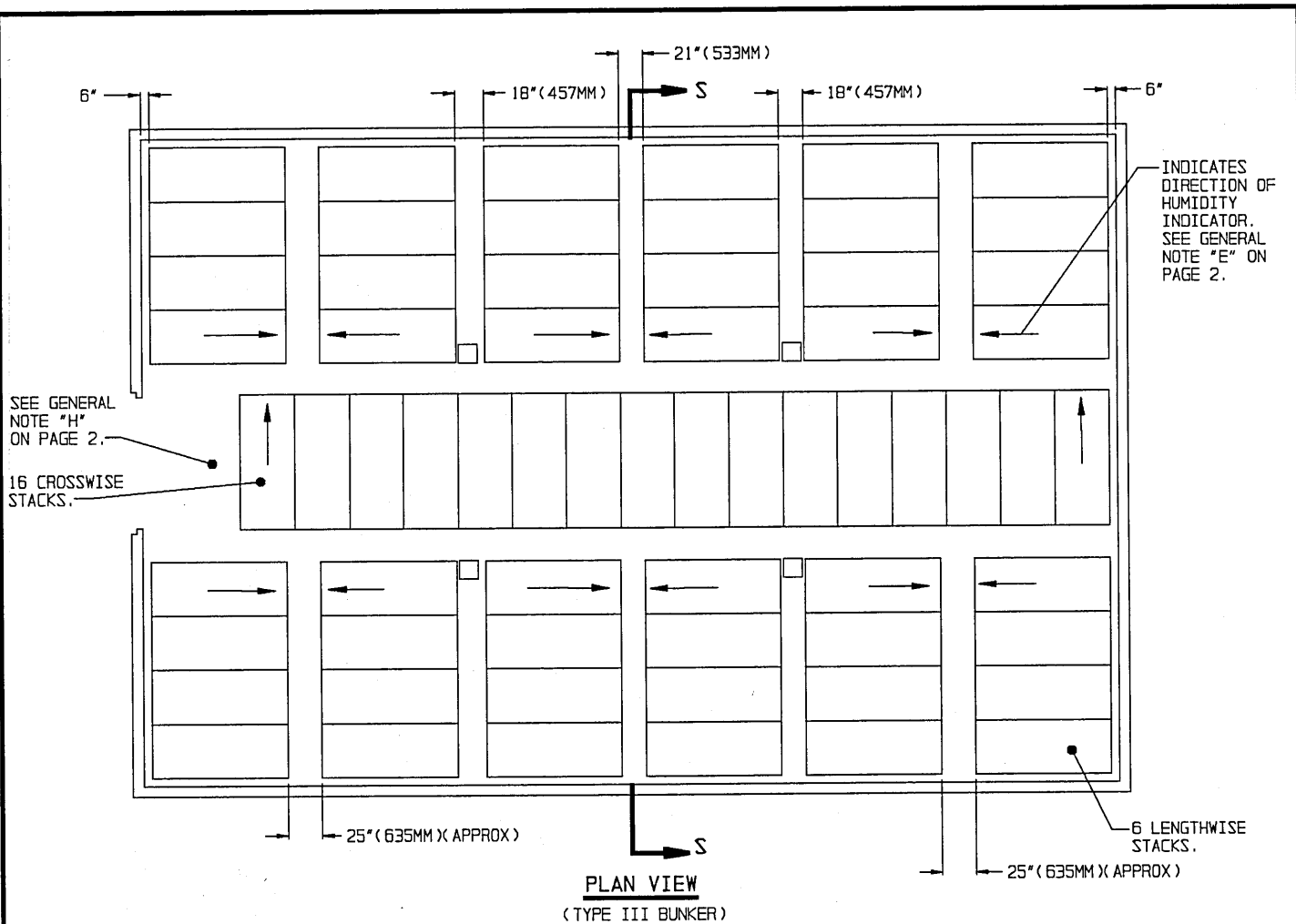

STORAGE IN TYPE III BUNKER

<u>ITEM</u>	<u>QUANTITY</u>
CONTAINERS - - - - -	296

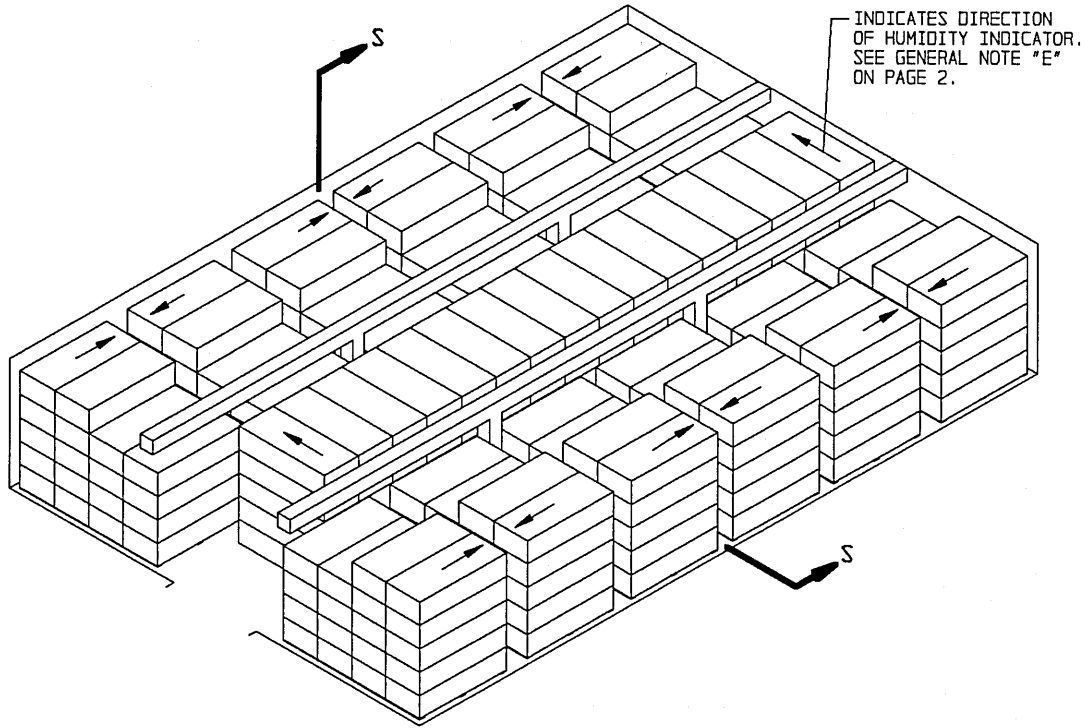

ISOMETRIC VIEW
(TYPE III BUNKER)

<u>BILL OF MATERIAL (PER STACK) *</u>		
<u>TYPE OF STACK</u>	<u>1" X 6" DUNNAGE LUMBER</u>	
	<u>LINEAR FEET</u>	<u>BOARD FEET</u>
<u>LENGTHWISE</u>	10	5
<u>CROSSWISE</u>	16	8

* SEE GENERAL NOTE "G" ON PAGE 2.

FOR "GENERAL NOTES" AND "MATERIAL SPECIFICATIONS" SEE PAGE 2.

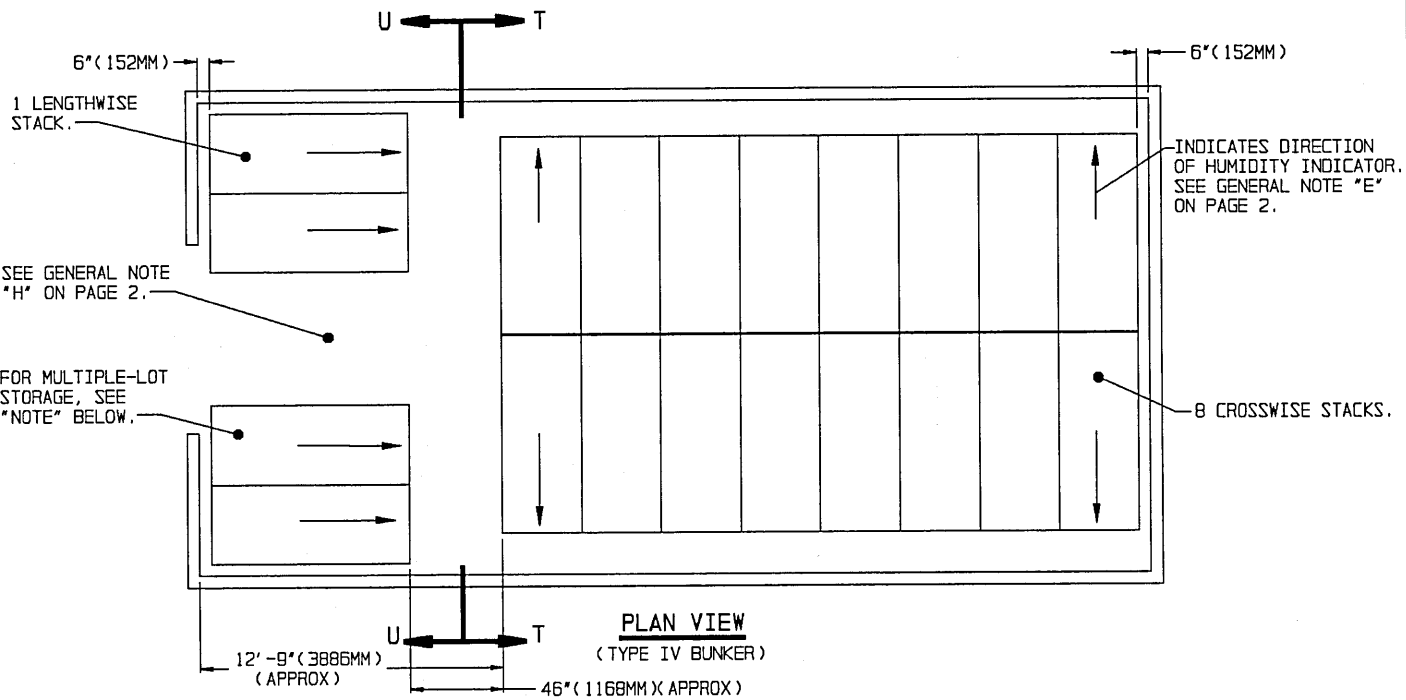

NOTE: FOR MULTIPLE-LOT STORAGE, CONTAINERS WILL BE POSITIONED IN THE MAGAZINE AS DEPICTED IN THE "PLAN VIEW" ON PAGE 33. FOR THE DEPICTED MAGAZINE, CONTAINERS CAN BE POSITIONED TWO (2) DEEP ON ONE SIDE OF THE MAGAZINE OR ONE (1) ON EACH SIDE OF THE MAGAZINE. IN EITHER CASE ONE OR MORE LOTS (NOT TO EXCEED 12 LIFTS) CAN BE STORED AT THE REAR OF THE MAGAZINE AS SHOWN ON PAGE 33. HOWEVER, COMPLIANCE WITH ALL OF THE MULTIPLE-LOT CRITERIA SPECIFIED IN THE "SPECIAL NOTES" ON PAGE 33 MUST BE OBSERVED.

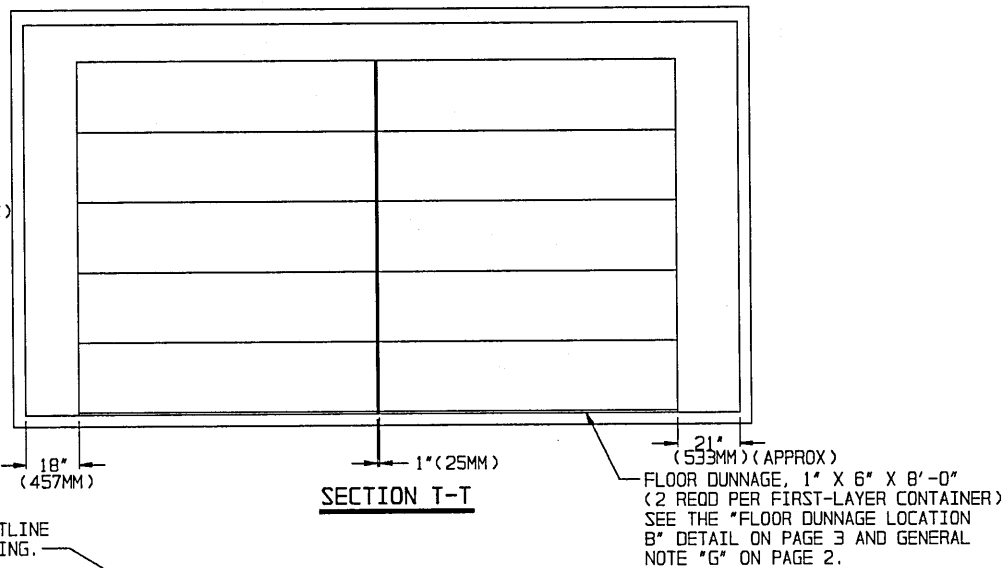

INDICATES OUTLINE OF DOOR OPENING.

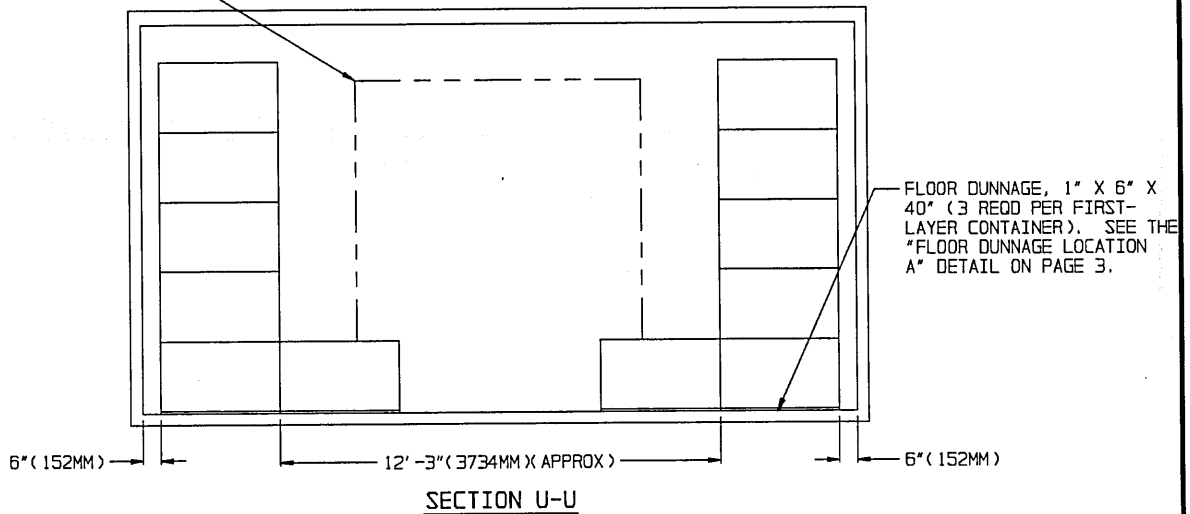

STORAGE IN TYPE IV BUNKER

ITEM	QUANTITY
CONTAINERS - - - - -	92

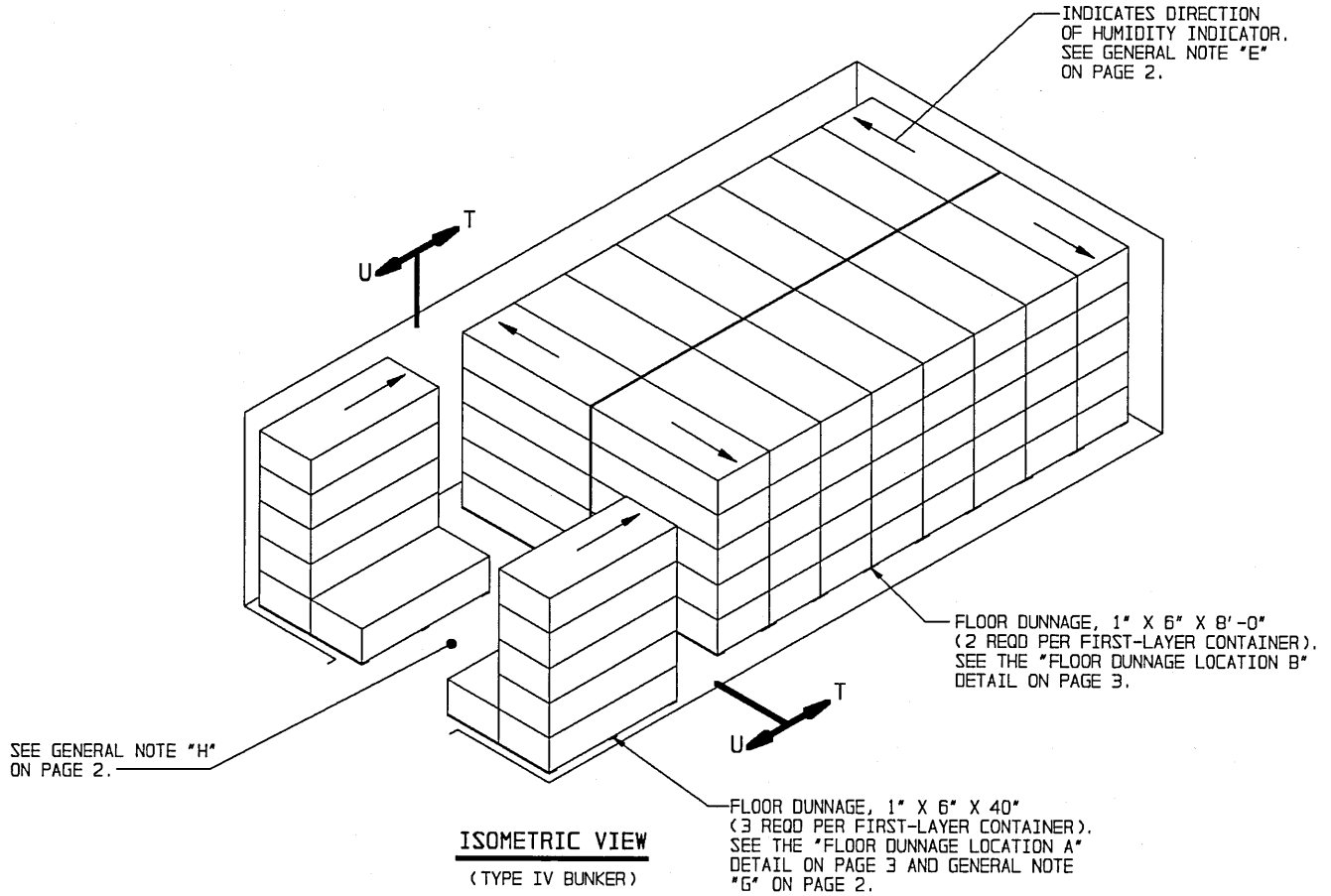

BILL OF MATERIAL (PER STACK) *		
TYPE OF STACK	1" X 6" DUNNAGE LUMBER	
	LINEAR FEET	BOARD FEET
LENGTHWISE	10	5
CROSSWISE	16	8

* SEE GENERAL NOTE "G" ON PAGE 2.

FOR "GENERAL NOTES" AND "MATERIAL SPECIFICATIONS" SEE PAGE 2.

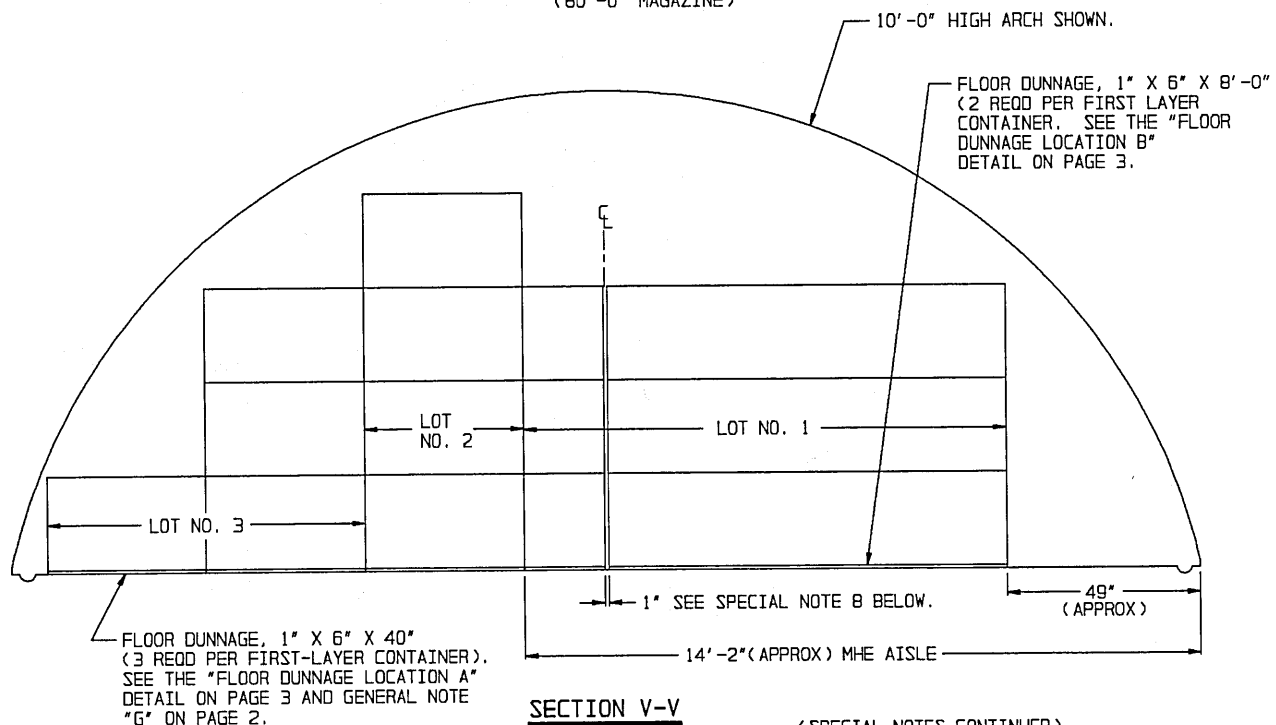
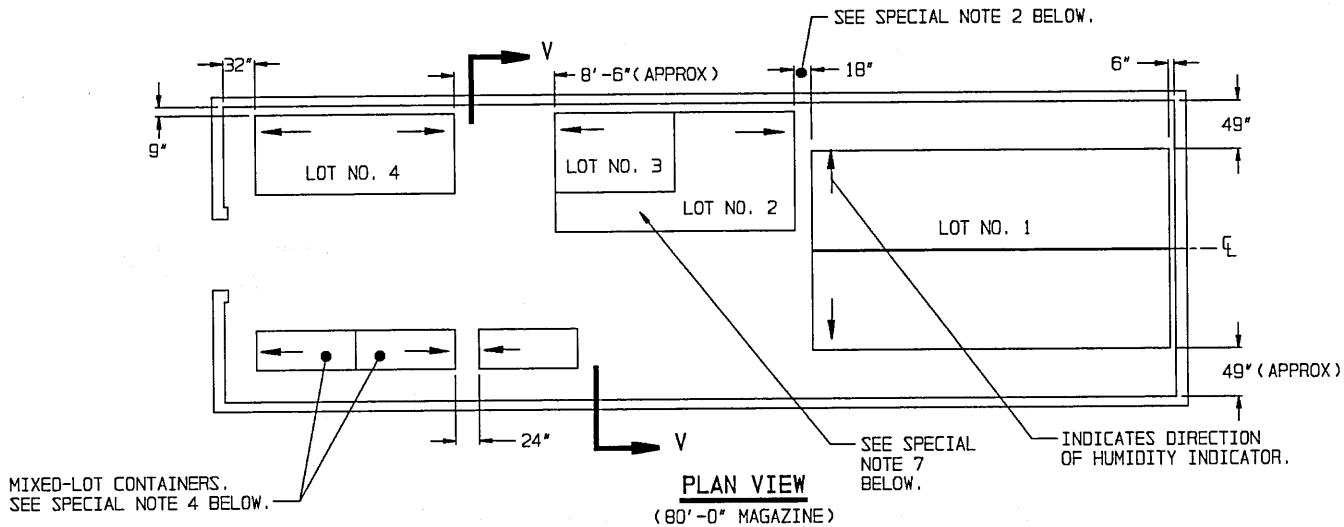

SPECIAL NOTES:

1. THE STORAGE PLANS AND CONFIGURATIONS SHOWN ON THIS PAGE ARE TYPICAL ONLY. ADAPTATIONS MAY BE MADE AS NUMBER AND SIZES OF LOTS TO BE STORED IN MAGAZINE REQUIRE.
2. AISLE DIMENSIONS SHOWN HEREIN MAY BE ADJUSTED TO SUIT LOCAL CONDITIONS AND/OR AVAILABLE HANDLING EQUIPMENT, HOWEVER, AN 18" (MIN) INSPECTION AISLE MUST BE MAINTAINED FOR INSPECTION OF HUMIDITY INDICATORS.
3. GENERALLY, THE LARGEST LOT SHOULD BE STORED IN THE REAR OF THE MAGAZINE. HOWEVER, THE REAR AREA MAY BE USED TO STORE MORE THAN ONE LOT BY ERECTING STACKS SIMILAR TO THOSE SHOWN IN THE FRONTAL AREA. AN MHE AISLE WILL BE REQUIRED ON ONE SIDE OF THE MAGAZINE, AND EACH LOT MUST BE ACCESSIBLE FOR REMOVAL AND INSPECTION/INVENTORY IN ACCORDANCE WITH OTHER CRITERIA SPECIFIED IN THESE SPECIAL NOTES AND IN THE GENERAL NOTES ON PAGE 2.
4. A MIXED-LOT CONTAINER WILL HAVE TWO ROUNDS OF DIFFERENT LOTS. BOTH ROUNDS MUST HAVE THE SAME NATIONAL STOCK NUMBER AND CONDITION CODE.
5. EACH LOT WITHIN THE MAGAZINE MUST BE ACCESSIBLE FOR MOVEMENT BY MHE. CONTAINERS OF A SINGLE-LOT OR MIXED-LOT CONTAINERS ARE CONSIDERED "ACCESSIBLE" IF NOT MORE THAN (TWELVE (12) LIFTS OF ANOTHER LOT OR LOTS HAVE TO BE MADE TO GAIN ACCESS TO THE SINGLE-LOT OR MIXED-LOT CONTAINERS. A "LIFT" MAY CONSIST OF ONE (1) OR MORE CONTAINERS, PROVIDING THE CAPACITY OF MHE PERMITS, AND SAFE HANDLING IS NOT JEOPARDIZED.
6. FOR STORAGE OF MULTIPLE LOTS, THE DISTANCE FROM THE SIDEWALL WILL BE BASED ON THE OVERHEAD CLEARANCE REQUIRED FOR MHE.
7. WHEN TWO LOTS ARE STORED ADJACENT TO EACH OTHER, THEY SHOULD BE SEPARATED BY AT LEAST 1" TO PROVIDE CLEARANCE FOR REMOVAL OF EITHER LOT.
8. A SEPARATION OF AT LEAST 1" MUST BE PROVIDED BETWEEN ROWS IN ONE LOT TO PROVIDE CLEARANCE FOR REMOVAL.

(CONTINUED AT RIGHT)

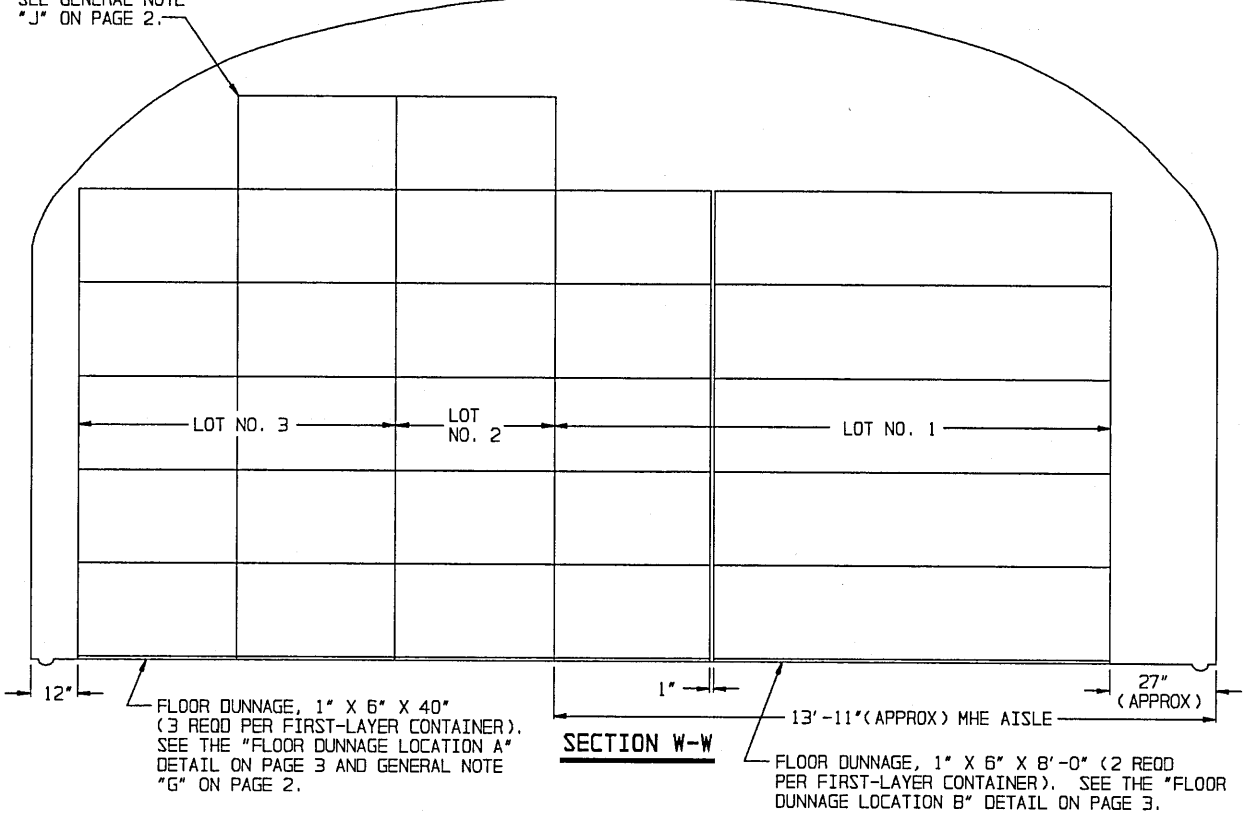
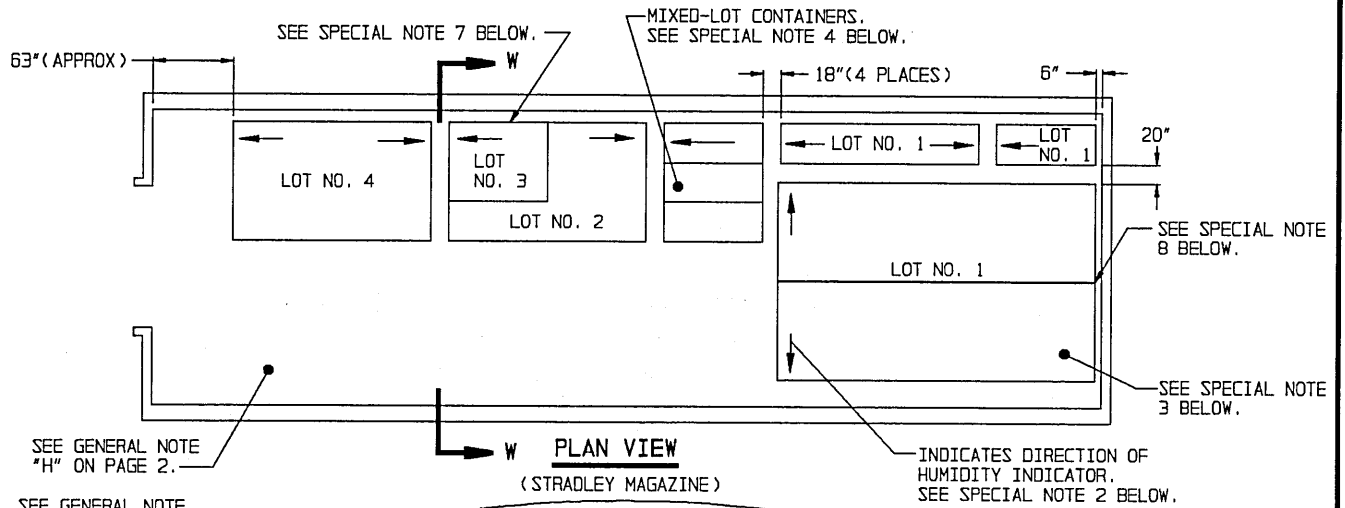

SPECIAL NOTES:

1. THE STORAGE PLANS AND CONFIGURATIONS SHOWN ON THIS PAGE ARE TYPICAL ONLY. ADAPTATIONS MAY BE MADE AS NUMBER AND SIZES OF LOTS TO BE STORED IN MAGAZINE REQUIRE.
2. AISLE DIMENSIONS SHOWN HEREIN MAY BE ADJUSTED TO SUIT LOCAL CONDITIONS AND/OR AVAILABLE HANDLING EQUIPMENT, HOWEVER, AN 18" (MIN) INSPECTION AISLE MUST BE MAINTAINED FOR INSPECTION OF HUMIDITY INDICATORS.
3. GENERALLY, THE LARGEST LOT SHOULD BE STORED IN THE REAR OF THE MAGAZINE. HOWEVER, THE REAR AREA MAY BE USED TO STORE MORE THAN ONE LOT BY ERECTING STACKS SIMILAR TO THOSE SHOWN IN THE FRONTAL AREA. AN MHE AISLE WILL BE REQUIRED ON ONE SIDE OF THE MAGAZINE, AND EACH LOT MUST BE ACCESSIBLE FOR REMOVAL AND INSPECTION/INVENTORY IN ACCORDANCE WITH OTHER CRITERIA SPECIFIED IN THESE SPECIAL NOTES AND IN THE GENERAL NOTES ON PAGE 2.
4. A MIXED-LOT CONTAINER WILL HAVE TWO ROUNDS OF DIFFERENT LOTS. BOTH ROUNDS MUST HAVE THE SAME NATIONAL STOCK NUMBER AND CONDITION CODE.

(SPECIAL NOTES CONTINUED)

5. EACH LOT WITHIN THE MAGAZINE MUST BE ACCESSIBLE FOR MOVEMENT BY MHE. CONTAINERS OF A SINGLE-LOT OR MIXED-LOT CONTAINERS ARE CONSIDERED "ACCESSIBLE" IF NO MORE THAN TWELVE (12) "LIFTS" OF ANOTHER LOT OR LOTS HAVE TO BE MADE TO GAIN ACCESS TO THE SINGLE-LOT OR MIXED-LOT CONTAINERS. A "LIFT" MAY CONSIST OF ONE (1) OR MORE CONTAINERS, PROVIDING THE CAPACITY OF MHE PERMITS, AND SAFE HANDLING IS NOT JEOPARDIZED.
6. FOR STORAGE OF MULTIPLE LOTS, THE DISTANCE FROM THE SIDEWALL WILL BE BASED ON THE OVERHEAD CLEARANCE REQUIRED FOR MHE.
7. WHEN TWO LOTS ARE STORED ADJACENT TO EACH OTHER, THEY SHOULD BE SEPARATED BY AT LEAST 1" TO PROVIDE CLEARANCE FOR REMOVAL OF EITHER LOT.
8. A SEPARATION OF AT LEAST 1" MUST BE PROVIDED BETWEEN ROWS IN ONE LOT TO PROVIDE CLEARANCE FOR REMOVAL.

(CONTINUED AT RIGHT)

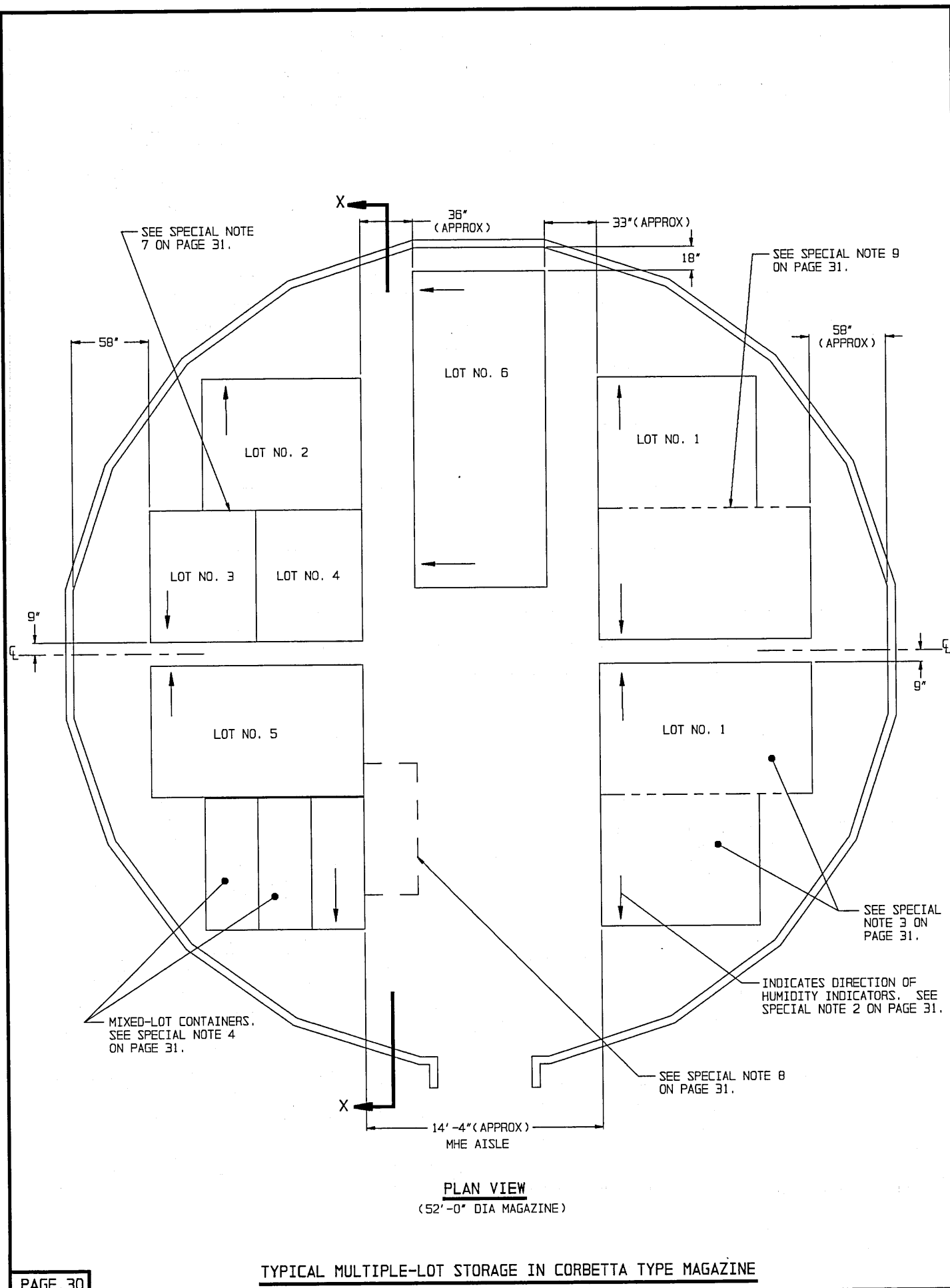

TYPICAL MULTIPLE-LOT STORAGE IN CORBETTA TYPE MAGAZINE

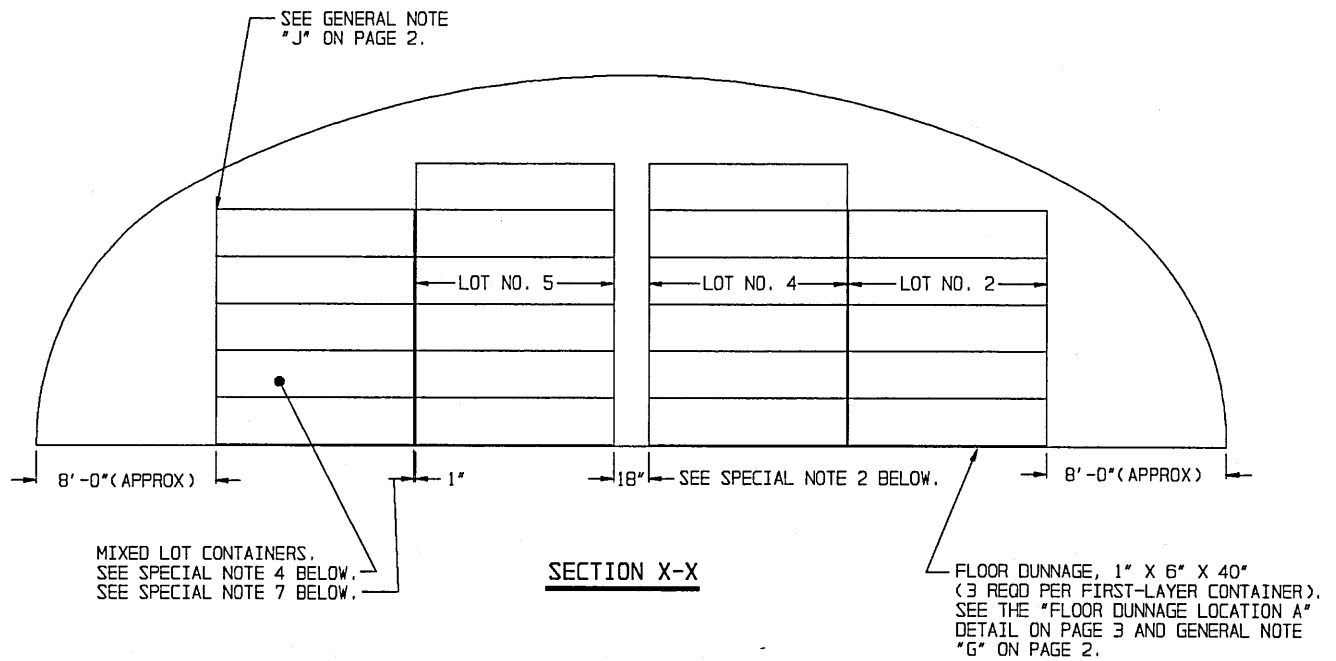

SPECIAL NOTES:

1. THE STORAGE PLANS AND CONFIGURATIONS SHOWN ON THIS PAGE AND ON PAGE 30 ARE TYPICAL ONLY. ADAPTATIONS MAY BE MADE AS NUMBER AND SIZES OF LOTS TO BE STORED IN MAGAZINE REQUIRE.
2. AN INSPECTION/INVENTORY AISLE NOT LESS THAN 18" WIDE MUST BE PROVIDED FOR INSPECTION OF HUMIDITY INDICATORS.
3. GENERALLY, THE LARGEST LOT SHOULD BE STORED ON ONE SIDE OF THE MAGAZINE. HOWEVER, BOTH SIDES MAY BE USED TO STORE MORE THAN ONE LOT BY ERECTING STACKS SIMILAR TO THOSE SHOWN ON THE LEFT SIDE. EACH ADDITIONAL LOT MUST BE ACCESSIBLE FOR REMOVAL AND INSPECTION/INVENTORY IN ACCORDANCE WITH OTHER CRITERIA SPECIFIED IN THESE SPECIAL NOTES AND IN THE GENERAL NOTES ON PAGE 2.
4. A MIXED-LOT CONTAINER WILL HAVE TWO ROUNDS OF DIFFERENT LOTS. BOTH ROUNDS MUST HAVE THE SAME NATIONAL STOCK NUMBER AND CONDITION CODE.
5. EACH LOT WITHIN THE MAGAZINE MUST BE ACCESSIBLE FOR MOVEMENT BY MHE. CONTAINERS OF A SINGLE-LOT OR MIXED-LOT CONTAINERS ARE CONSIDERED "ACCESSIBLE" IF NOT MORE THAN TWELVE (12) "LIFTS" OF ANOTHER LOT OR LOTS HAVE TO BE MADE TO GAIN ACCESS TO THE SINGLE-LOT OR MIXED-LOT CONTAINERS. A "LIFT" MAY CONSIST OF ONE (1) OR MORE CONTAINERS, PROVIDING THE CAPACITY OF MHE PERMITS, AND SAFE HANDLING IS NOT JEOPARDIZED.
6. FOR STORAGE OF MULTIPLE LOTS, THE DISTANCE FROM THE WALL WILL BE BASED ON THE OVERHEAD CLEARANCE REQUIRED FOR MHE.
7. WHEN TWO LOTS ARE STORED ADJACENT TO EACH OTHER, THEY SHOULD BE SEPARATED BY AT LEAST 1" TO PROVIDE CLEARANCE FOR REMOVAL OF EITHER LOT.
8. THE MHE AISLE MAY BE USED TO STORE ONE OR MORE STACKS OF ADDITIONAL LOTS OR ADDITIONAL ITEMS THAT ARE FROM A LOT ADJACENT TO THE MHE AISLE. FOR THE "ADDITIONAL STORAGE LOCATIONS" (SHOWN BY DOTTED LINES), ADEQUATE SPACE FOR THE MHE OPERATION MUST BE MADE AVAILABLE. ALSO, COMPLIANCE WITH ALL OF THE MULTIPLE-LOT CRITERIA AS SET FORTH ON THIS PAGE MUST BE OBSERVED.
9. SEPARATION OF AT LEAST 1" MUST BE PROVIDED BETWEEN ROWS IN ONE LOT TO PROVIDE CLEARANCE FOR REMOVAL. THIS SEPARATION IS INDICATED BY THE PHANTOM LINES IN THE PLAN VIEW ON PAGE 30.

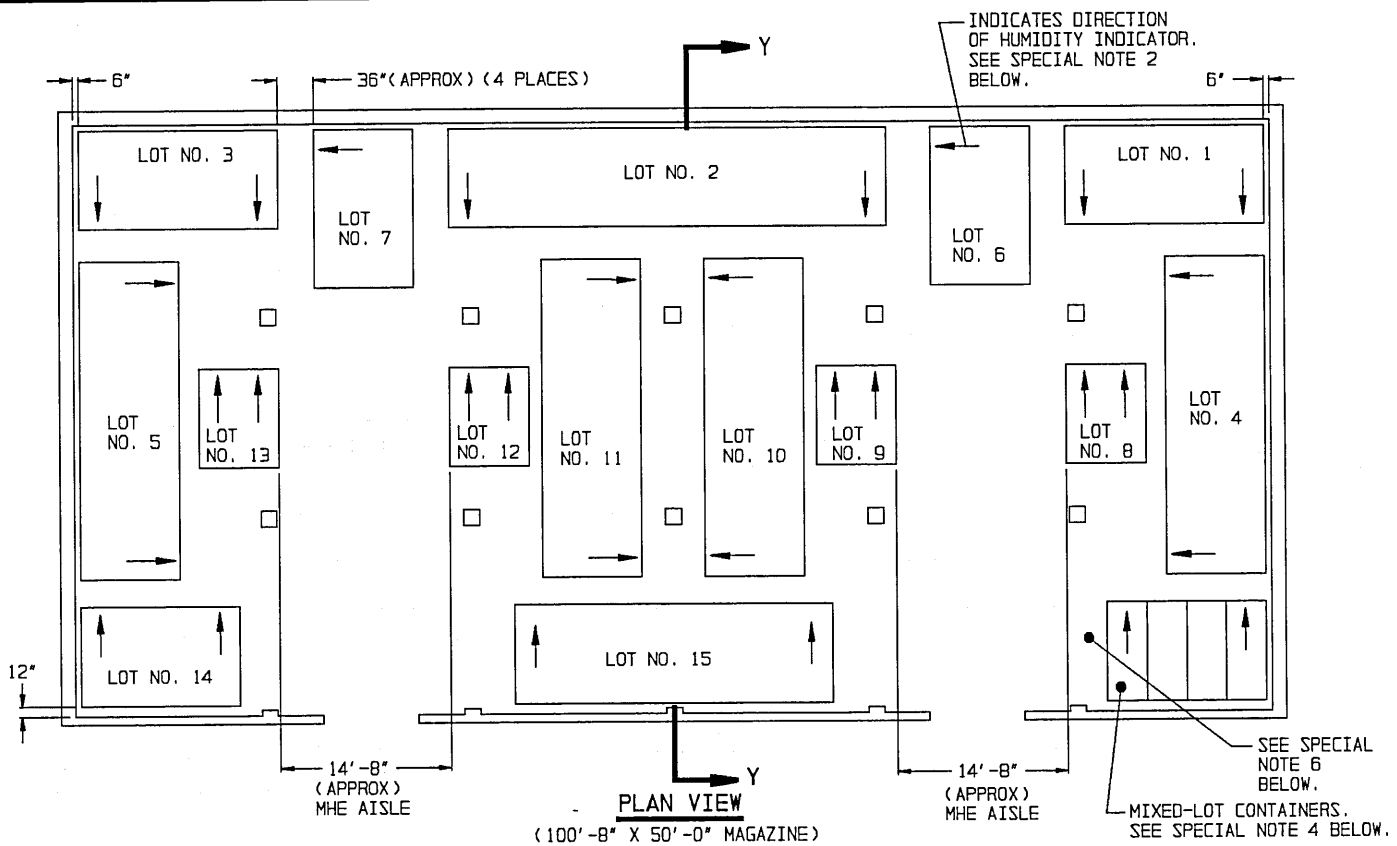

SPECIAL NOTES:

1. THE STORAGE PLANS SHOWN ARE TYPICAL ONLY. ADAPTATIONS MAY BE MADE AS NUMBER AND SIZES OF LOTS TO BE STORED IN MAGAZINE REQUIRE.
2. AISLE DIMENSIONS SHOWN HEREIN MAY BE ADJUSTED TO SUIT LOCAL CONDITIONS AND/OR AVAILABLE HANDLING EQUIPMENT. HOWEVER, AN 18" (MIN) INSPECTION AISLE MUST BE MAINTAINED FOR INSPECTION OF HUMIDITY INDICATORS.
3. EACH LOT WITHIN THE MAGAZINE MUST BE ACCESSIBLE FOR MOVEMENT BY MHE. CONTAINERS OF A SINGLE-LOT OR MIXED-LOT CONTAINERS ARE CONSIDERED "ACCESSIBLE" IF NO MORE THAN TWENTY-FOUR (24) "LIFTS" OF ANOTHER LOT OR LOTS HAVE TO BE MADE TO GAIN ACCESS TO THE SINGLE-LOT OR MIXED-LOT CONTAINERS. A "LIFT" MAY CONSIST OF ONE (1) OR MORE CONTAINERS, PROVIDING THE CAPACITY OF MHE PERMITS AND SAFE HANDLING IS NOT JEOPARDIZED.
4. A MIXED-LOT CONTAINER WILL HAVE TWO ROUNDS OF DIFFERENT LOTS. BOTH ROUNDS MUST HAVE THE SAME NATIONAL STOCK NUMBER AND CONDITION CODE.

(SPECIAL NOTES CONTINUED)

5. WHEN TWO LOTS ARE STORED ADJACENT TO EACH OTHER, THEY SHOULD BE SEPARATED BY AT LEAST 1" TO PROVIDE CLEARANCE FOR REMOVAL OF EITHER LOT.
6. THE MHE AISLE MAY BE USED TO STORE ONE OR MORE STACKS OF ADDITIONAL LOTS OR ADDITIONAL ITEMS THAT ARE FROM A LOT ADJACENT TO THE MHE AISLE. HOWEVER, COMPLIANCE WITH ALL OF THE MULTIPLE-LOT CRITERIA AS SET FORTH ON THIS PAGE MUST BE OBSERVED.

(CONTINUED AT RIGHT)

CONTAINERS IN TOP LAYER WILL BE OMITTED AS REQUIRED TO CLEAR ROOF SUPPORT CAPS AT TOP OF COLUMNS.

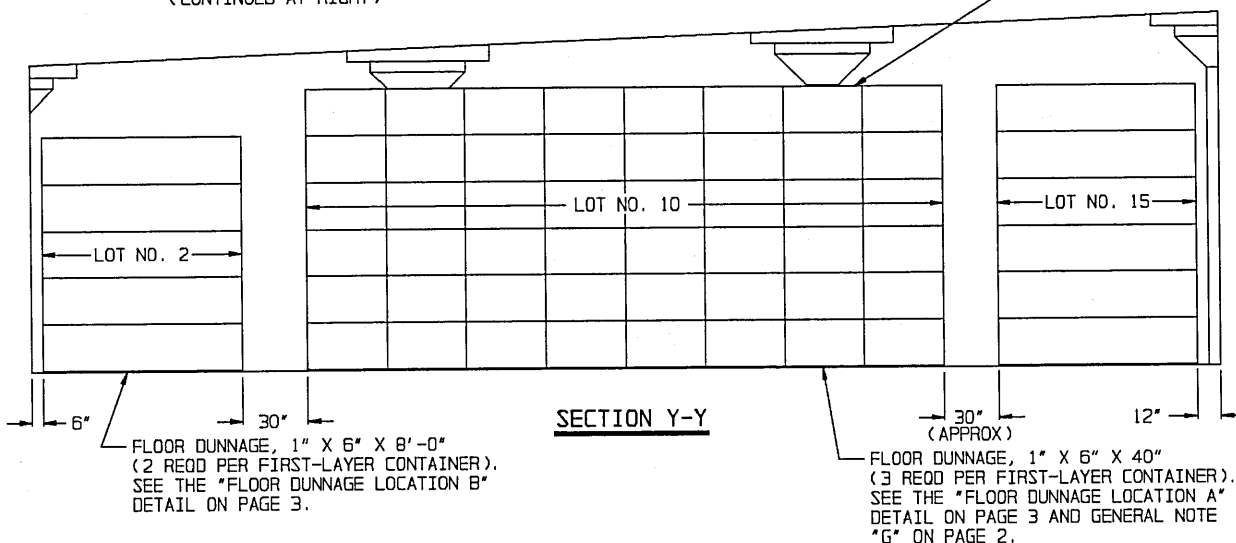

TYPICAL MULTIPLE-LOT STORAGE IN RECTANGULAR MAGAZINE

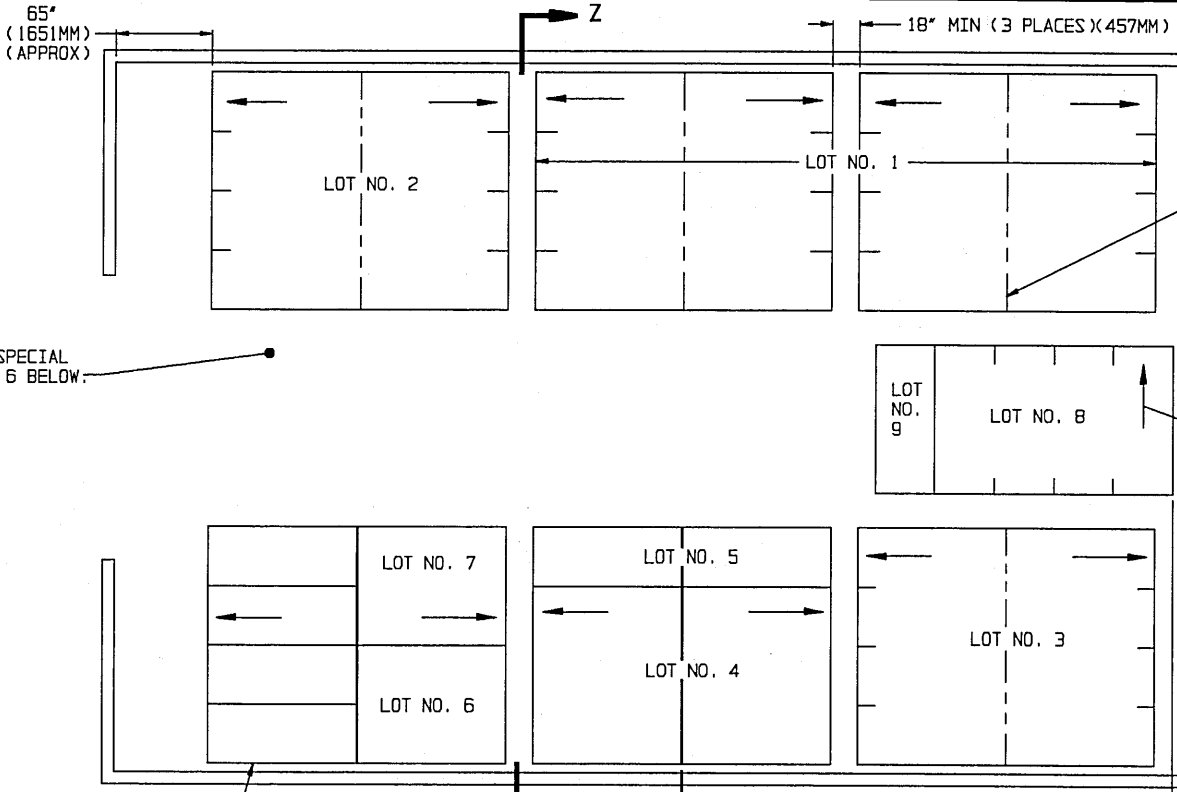

SEE SPECIAL NOTE 6 BELOW.

SEE SPECIAL NOTE 7 BELOW.

INDICATE LOCATION OF HUMIDITY INDICATORS. SEE SPECIAL NOTE 2 BELOW.

MIXED-LOT CONTAINERS. SEE SPECIAL NOTE 4 BELOW.

1" SEE SPECIAL NOTE 5 BELOW.

PLAN VIEW
(TYPE II BUNKER)

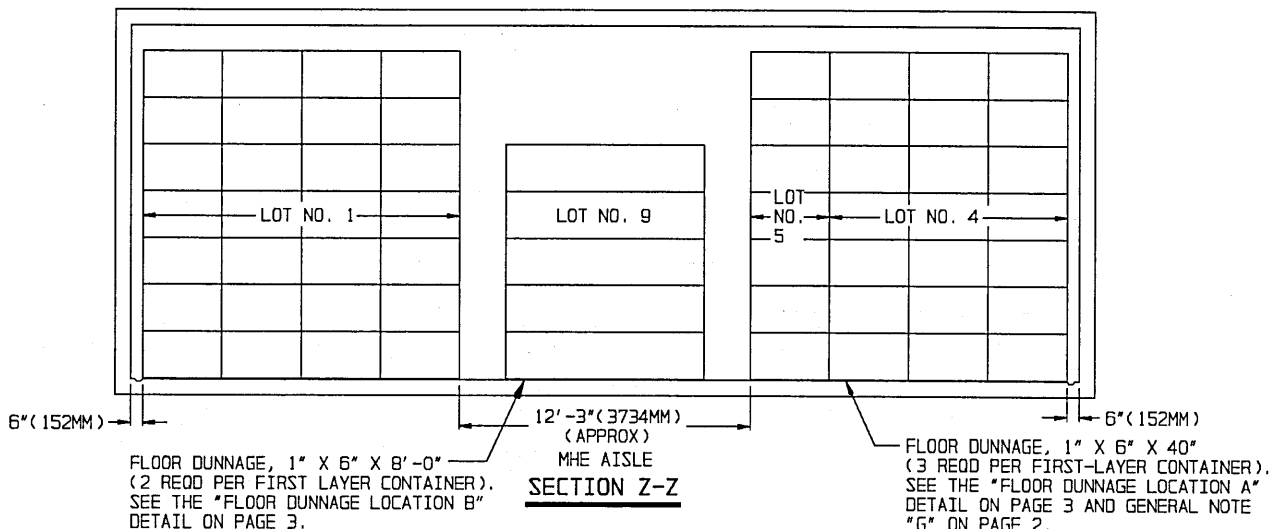

FLOOR DUNNAGE, 1" X 6" X 8'-0"
(2 REQ PER FIRST LAYER CONTAINER).
SEE THE "FLOOR DUNNAGE LOCATION B"
DETAIL ON PAGE 3.

SECTION Z-Z

FLOOR DUNNAGE, 1" X 6" X 40"
(3 REQ PER FIRST-LAYER CONTAINER).
SEE THE "FLOOR DUNNAGE LOCATION A"
DETAIL ON PAGE 3 AND GENERAL NOTE
"G" ON PAGE 2.

SPECIAL NOTES:

(SPECIAL NOTES CONTINUED)

1. THE STORAGE PLANS SHOWN ARE TYPICAL ONLY. ADAPTATIONS MAY BE MADE AS NUMBER AND SIZES OF LOTS TO BE STORED IN MAGAZINE REQUIRE.
2. AISLE DIMENSIONS SHOWN HEREIN MAY BE ADJUSTED TO SUIT LOCAL CONDITIONS AND/OR AVAILABLE HANDLING EQUIPMENT, HOWEVER, AN 18" (MIN) INSPECTION AISLE MUST BE MAINTAINED FOR INSPECTION OF HUMIDITY INDICATORS.
3. EACH LOT WITHIN THE MAGAZINE MUST BE ACCESSIBLE FOR MOVEMENT BY MHE. CONTAINERS OF A SINGLE-LOT OR MIXED-LOT CONTAINERS ARE CONSIDERED "ACCESSIBLE" IF NOT MORE THAN TWELVE (12) "LIFTS" OF ANOTHER LOT OR LOTS HAVE TO BE MADE TO GAIN ACCESS TO THE SINGLE-LOT OR MIXED-LOT CONTAINER. A "LIFT" MAY CONSIST OF ONE (1) OR MORE CONTAINERS, PROVIDING THE CAPACITY OF MHE PERMITS AND SAFE HANDLING IS NOT JEOPARDIZED.
4. A MIXED-LOT CONTAINER WILL HAVE TWO ROUNDS OF DIFFERENT LOTS. BOTH ROUNDS MUST HAVE THE SAME NATIONAL STOCK NUMBER AND CONDITION CODE.
5. WHEN TWO LOTS ARE STORED ADJACENT TO EACH OTHER, THEY SHOULD BE SEPARATED BY AT LEAST 1" TO PROVIDE CLEARANCE FOR REMOVAL OF EITHER LOT.
6. THE MHE AISLE MAY BE USED TO STORE ONE OR MORE STACKS OF ADDITIONAL LOTS OR ADDITIONAL ITEMS THAT ARE FROM A LOT ADJACENT TO THE MHE AISLE. HOWEVER, COMPLIANCE WITH ALL OF THE MULTIPLE-LOT CRITERIA AS SET FORTH ON THIS PAGE MUST BE OBSERVED.
7. A SEPARATION OF AT LEAST 1" MUST BE PROVIDED BETWEEN ROWS IN ONE LOT TO PROVIDE CLEARANCE FOR REMOVAL. THIS SEPARATION IS INDICATED BY THE PHANTOM LINES IN THE PLAN VIEW ABOVE.

(CONTINUED AT RIGHT)

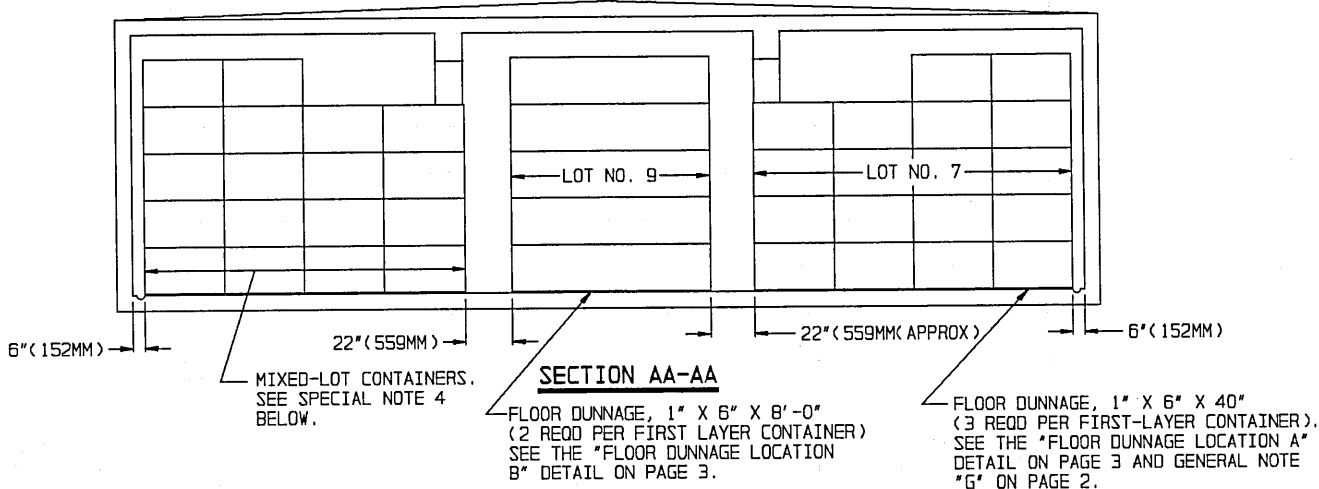
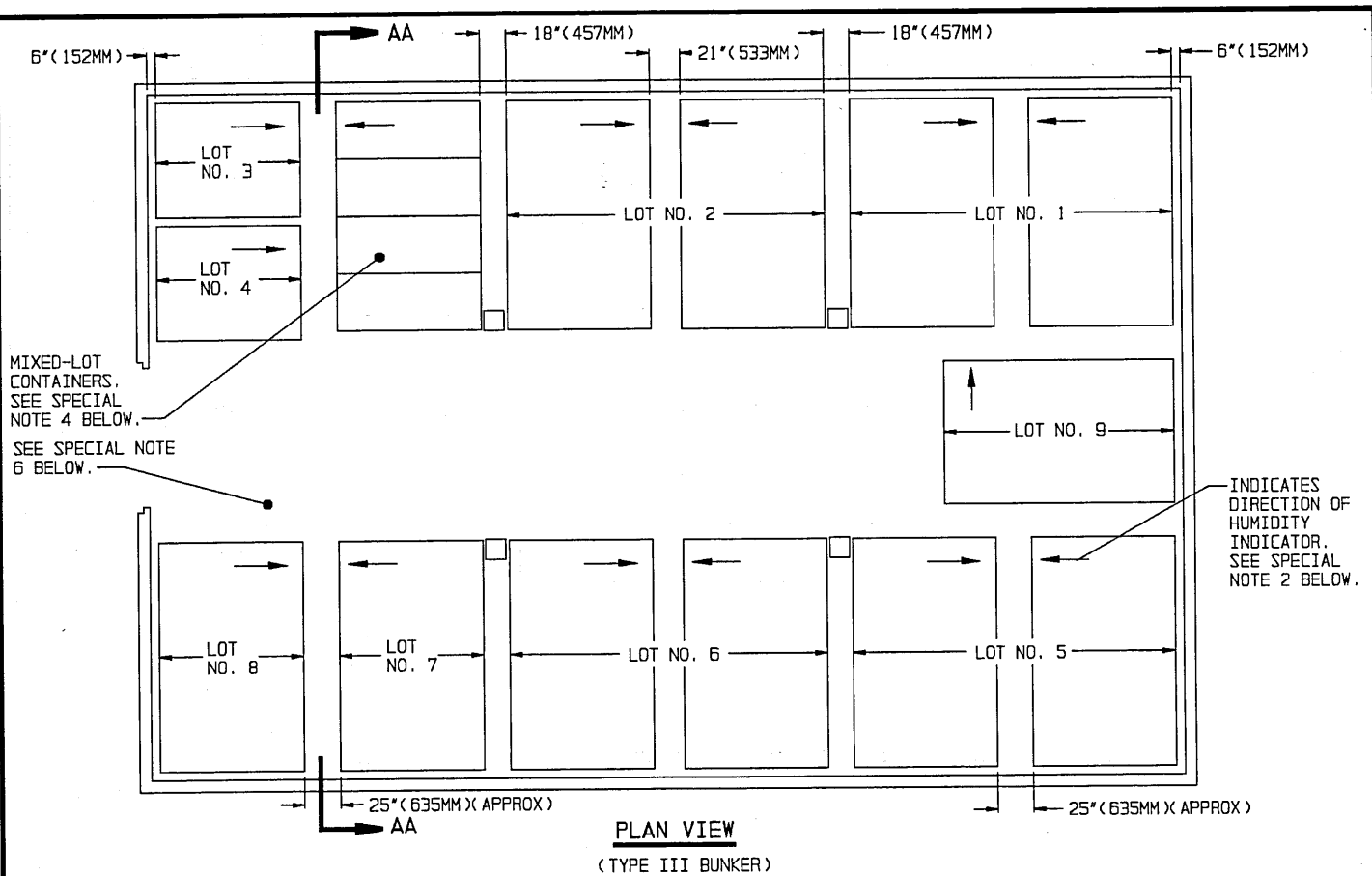

SPECIAL NOTES:

1. THE STORAGE PLANS SHOWN ARE TYPICAL ONLY. ADAPTATIONS MAY BE MADE AS NUMBER AND SIZES OF LOTS TO BE STORED IN MAGAZINE REQUIRE.
2. AISLE DIMENSIONS SHOWN HEREIN MAY BE ADJUSTED TO SUIT LOCAL CONDITIONS AND/OR AVAILABLE HANDLING EQUIPMENT. HOWEVER, AN 18" (MIN) INSPECTION AISLE MUST BE MAINTAINED FOR INSPECTION OF HUMIDITY INDICATORS.
3. EACH LOT WITHIN THE MAGAZINE MUST BE ACCESSIBLE FOR MOVEMENT BY MHE. CONTAINERS OF A SINGLE-LOT OR MIXED-LOT CONTAINERS ARE CONSIDERED "ACCESSIBLE" IF NO MORE THAN TWELVE (12) "LIFTS" OF ANOTHER LOT OR LOTS HAVE TO BE MADE TO GAIN ACCESS TO THE SINGLE-LOT OR MIXED-LOT CONTAINERS. A "LIFT" MAY CONSIST OF ONE (1) OR MORE CONTAINERS, PROVIDING THE CAPACITY OF MHE PERMITS AND SAFE HANDLING IS NOT JEOPARDIZED.
4. A MIXED-LOT CONTAINER WILL HAVE TWO ROUNDS OF DIFFERENT LOTS. BOTH ROUNDS MUST HAVE THE SAME NATIONAL STOCK NUMBER AND CONDITION CODE.

(CONTINUED AT RIGHT)

(SPECIAL NOTES CONTINUED)

5. WHEN TWO LOTS ARE STORED ADJACENT TO EACH OTHER, THEY SHOULD BE SEPARATED BY AT LEAST 1" TO PROVIDE CLEARANCE FOR REMOVAL OF EITHER LOT.
6. THE MHE AISLE MAY BE USED TO STORE ONE OR MORE STACKS OF ADDITIONAL LOTS OR ADDITIONAL ITEMS THAT ARE FROM A LOT ADJACENT TO THE MHE AISLE. HOWEVER, COMPLIANCE WITH ALL OF THE MULTIPLE-LOT CRITERIA AS SET FORTH ON THIS PAGE MUST BE OBSERVED.